

Table for standard stroke

Tube I.D.	Stroke (mm)	Max. stroke (mm)
ø16	15,25,50,75,100,125,150,200	500
ø20	↑ 250,300	300
ø25		500

* Intermediate stroke are available, please contact us.

Tightening torque

Tube I.D.	Rod thread	Tightening torque (kgf·cm)
ø16	M6×1.0	41
ø20	M8×1.25	100
ø25	M10×1.25	190

* Make sure the tightening torque of rod thread does not exceed the value above.

* The tolerance of tightening torque is ±5%.

Features

- ISO 6432 standard.
- Stainless steel rod and tube for good corrosion resistance.
- Comprehensive types of mounting accessories available.
- Hexagonal rod design provides rod non-rotation function.
- Magnetic as standard.

Specification

Model	MCKMI			
Tube I.D. (mm)	16	20	25	
Port size	M5×0.8	G1/8		
Medium	Air			
Operating pressure range	0.06~0.7 MPa			
Proof pressure	1 MPa			
Lubricator	Not required			
Ambient temperature	-5°C~+60°C (No freezing)			
Available speed range	50~750 mm/sec			
Max. allowable kinetic energy (J)	Cushion pad	0.09	0.27	0.4
	Cushion air	—	0.66	0.97
Rod non-rotating accuracy	±1°	±0.7°		
Allowable rotational torque	0.4 kgf·cm	2.0 kgf·cm	2.5 kgf·cm	
Sensor switch (band) (*1)	RCM(BM16)	RCM(BM20)	RCM(BM25)	

*1. RCM specification, Please refer to page 8-16.

*2. The cylinder is allowed little leakage. Before the cylinder is sale, it has passed the standard of leakage test.

*3. For precautions, please refer to page 3-2.

Order example

MCKMI - 11 - 20 - 100 - A - N

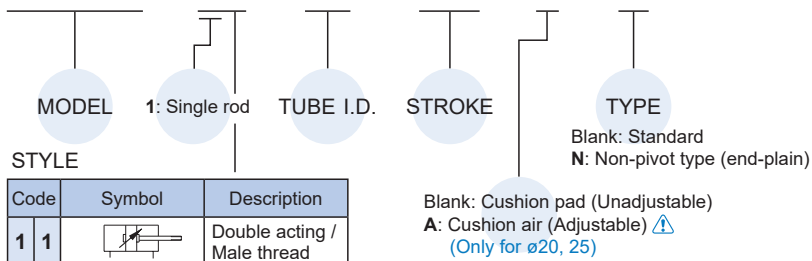





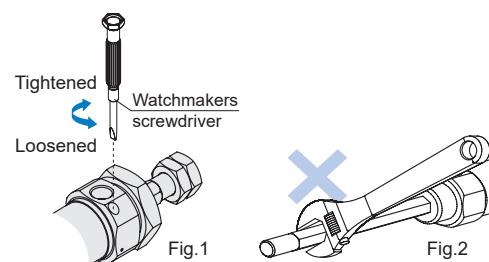

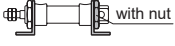
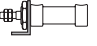

⚠️ Caution

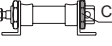
- For (A) Cushion air (Adjustable) (Fig.1)
 1. To adjust a cushion needle, please slowly turn the needle valve from the fully closed status to the required status which needs to be within 2.5 turns.
 2. If the needle valve loosen excessively, the buffer doesn't take effect and the lifetime of cylinder would be shortened.
- Please don't attempt to rotate the piston rod. (Fig.2)





Accessories & Connector

Accessories			
Code	LB (LB×2, with cover nut ×1)	LB (LB×1, without cover nut)	NUT
Cover type	Standard type	Non-pivot type (N)	–
Mounting Tube I.D.			Rod nut  Cover nut 
ø16	LB-M3-12x2	LB-M3-12	NUT-M6x1.0x5Hx10B NUT-M16x1.5x6Hx22B
ø20	LB-M3-20x2	LB-M3-20	NUT-M8x1.25x5Hx13B
ø25			NUT-M10x1.25x6Hx17B NUT-M22x1.5x6Hx30B

Accessories			Connector			
Code	FA	FB	SDB (with pin×1 + snap ring×2)	Y	I	YS (Y+Floating pin)
Cover type	All applicable	Standard type	Standard type	All applicable		
Mounting Tube I.D.						
ø16	FA-M3-12		SDB-M3-12	Y-M3-12	I-M3-12	YS-M3-16
ø20	FA-M3-20		SDB-M3-20	Y-M3-20	I-M3-20	YS-M3-20
ø25				Y-Q2-32	I-Q2-32	YS-Q2-32

* Y, I, YS, consulte la página 3-14.

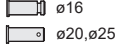
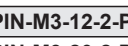
Pin

Applicable	YS connector	Y&I connector	SDB connector
Code	PIN-S	PIN-Y-P (with split pin / snap ring)	PIN-SDB-P (with snap ring)
Fig Tube I.D.		 ø16  ø20, ø25	
ø16	PIN-M3-16-S	PIN-M3-12-2-P	PIN-M3-12-1-P
ø20	PIN-M3-20-S	PIN-M3-20-2-P	PIN-M3-20-1-P
ø25	PIN-Q2-32-S	PIN-Q2-32-2-P	

Cylinder weight

Unit: g

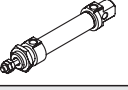
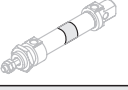
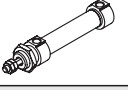
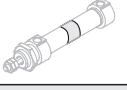
Model	Basic weight		Stroke 25mm	
	MCKMI	MCKMI	MCKMI*-N	MCKMI*-N
Tube I.D.				
ø16	69	13.0	62	13.0
ø20	126	20.3	116	20.3
ø25	168	28.7	153	28.7

Cushion pad

Unadjustable

ø16~ø25

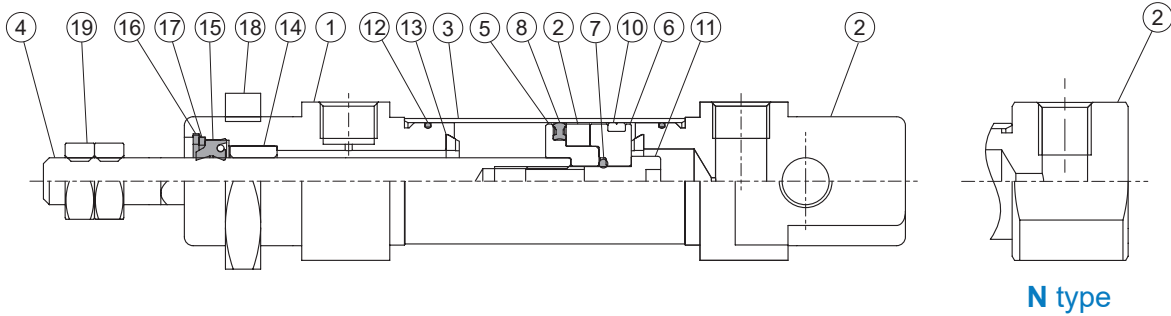

N type

Cushion air

Adjustable

ø20, ø25

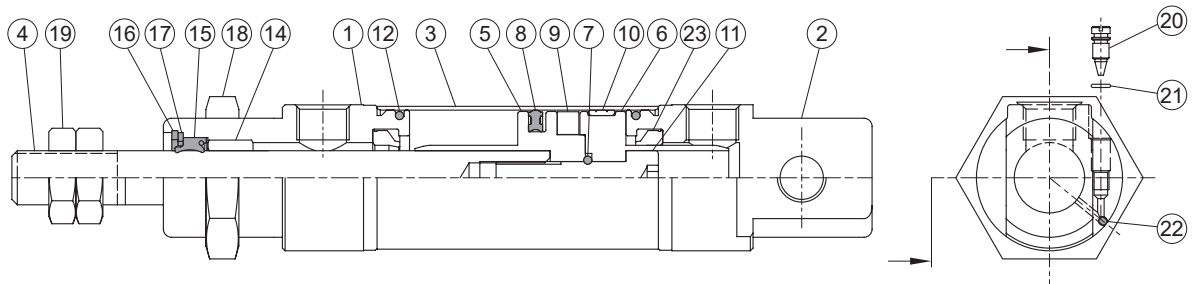

Material

No.	Cushion		Part name	Tube I.D.			Q'y	Component parts (inclusion)	
	Pad	Air		16	20	25		Pad	Air
1	●	●	Rod cover	Aluminum alloy			1	●	●
2	●	●	Head cover	Aluminum alloy			1	●	●
3	●	●	Tube	Stainless steel			1		
4	●	●	Piston rod	Stainless steel			1		
5	●	●	Piston-R	Aluminum alloy			1	●	●
6	●	●	Piston-H	Aluminum alloy			1	●	●
7	●	●	Piston gasket	NBR			1	●	●
8	●	●	Piston packing	NBR			1	●	●
9	●	●	Magnet ring	Magnet material			1	●	●
10	●	●	Wear ring	Resin			1	●	●
11	●	●	Piston bolt	SCM			1	●	●
12	●	●	Cover ring	NBR	-	2	●	●	
13	●	●	Cushion gasket	NBR	TPU	2	●	●	
14	●	●	Rod bush	Bearing alloy			1	●	●
15	●	●	Rod packing	NBR			1	●	●
16	●	●	Snap ring	Spring steel			1	●	●
17	●	●	Washer	Carbon steel			1	●	●
18	●	●	Tie nut	Carbon steel			1	●	●
19	●	●	Rod front nut	Carbon steel			2	●	●
20		●	Needle valve	Stainless steel			2		●
21		●	Needle valve packing	NBR			2		●
22		●	Steel ball	Stainless steel			2		●
23		●	Cushion packing	NBR			2		●

Order example Component parts

Tube I.D.	Cushion pad
ø16	CP-MCKMI-16
ø20	CP-MCKMI-20
ø25	CP-MCKMI-25

Tube I.D.	Cushion air
ø16	CP-MCKMI-16A
ø20	CP-MCKMI-20A
ø25	CP-MCKMI-25A

11

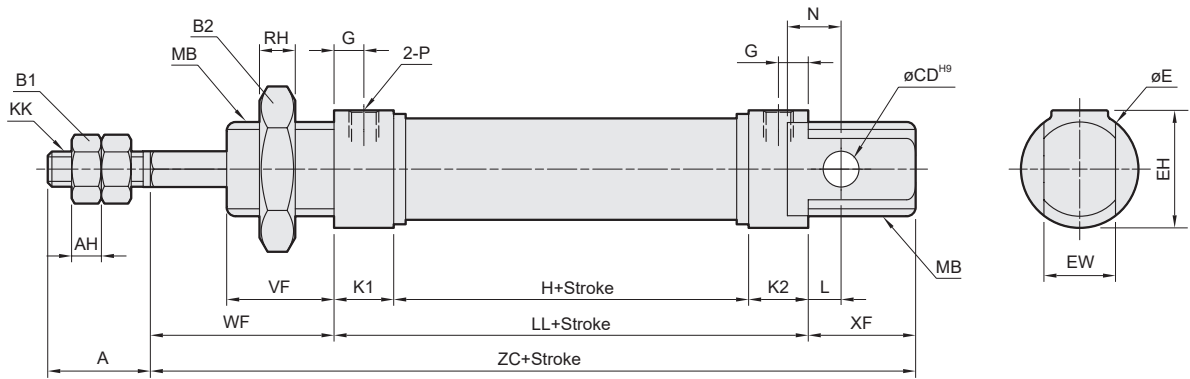

N

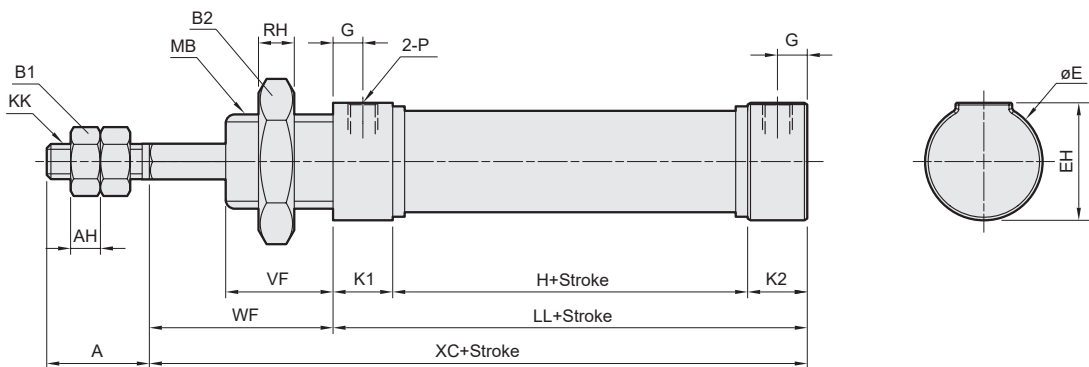

Code Tube I.D.	A	AH	B1	B2	CD	E	EH	EW	G	H	KK	K1	K2	L	LL	MB	N	P	RH	VF
16	16	5	10	22	6	20	20	12 ^{-0.05} _{-0.4}	5	34.5	M6×1	10	10	5.5	54.5	M16×1.5	9	M5×0.8	6	18
20	20	5	13	30	8	27	27	16 ^{-0.05} _{-0.4}	8	38	M8×1.25	15	15	3	68	M22×1.5	12	G1/8	6	20
25	22	6	17	30	8	27	27	16 ^{-0.05} _{-0.4}	7.5	37	M10×1.25	15	15	9	67	M22×1.5	12	G1/8	6	22

Code Tube I.D.	WF	XC	XF	ZC
16	22	76.5	18	94.5
20	24	92	20	112
25	28	95	22	117