

linear units

**Screw driven guided linear unit**

Linearantrieb mit Rundspindel und integrierter Kugelumlaufführung  
Attuatori lineari a vite e guida a ricircolo di sfere

	Carriages Laufwagen Carrelli	Max stroke Max Hub Corsa max	Min stroke Min Hub Corsa min	Pitch Steigung Passo vite	Ø screw** Ø gewinde** Ø vite**	Base weight Grundmasse Peso base	Add for 100 mm Masse pro 100 mm Hub Peso ogni 100 mm	Inertia moment Ix Flächenträgheitsmoment Momento d'inerzia Ix	Inertia moment Iy Flächenträgheitsmoment Momento d'inerzia Iy
		mm	mm	mm	mm	kg	kg	cm <sup>4</sup>	cm <sup>4</sup>
MUK40-1	1	1200	--	5 10	12	1,2	0,45	13	107
MUK40-2	2	1200	--	5 10	12	2,1	0,45		

	Pitch Steigung Passo vite	Max Fx*	Max Fy*	Max Fz*	Max Mx*	Max My*	Max Mz*
		N	N	N	Nm	Nm	Nm
MUK40-1	5	980	2750	2750	85	145	145
	10	750					
MUK40-2	5	980	3500	3500	210	350	350
	10	750					

\* The moments and the loads above are max. values. For any further information, please contact our technical department.

\* Die angegebenen Momente und Belastungen sind max. Werte, die nicht überschritten werden sollen. Für weitere Informationen wenden Sie sich bitte an unser Konstruktionsbüro.

\* I carichi e i momenti indicati sono massimi consigliati, per ulteriori informazioni consultare il ns ufficio tecnico.

$$\frac{F_{yA}}{F_y} + \frac{F_{zA}}{F_z} + \frac{M_{xA}}{M_x} + \frac{M_{yA}}{M_y} + \frac{M_{zA}}{M_z} \leq 1$$

\*\* Different types of screws are available, rolled or ground with different tolerances and trapezoidal screws.

\*\* Verschiedene Spindelvarianten sind verfügbar. Kugelrollspindeln geschliffen in verschiedenen Genauigkeitsklassen sowie Trapezspindeln.

\*\* Tipologie di viti disponibili: rullate, rettificate con diversi classi di precisione e trapezoidali.

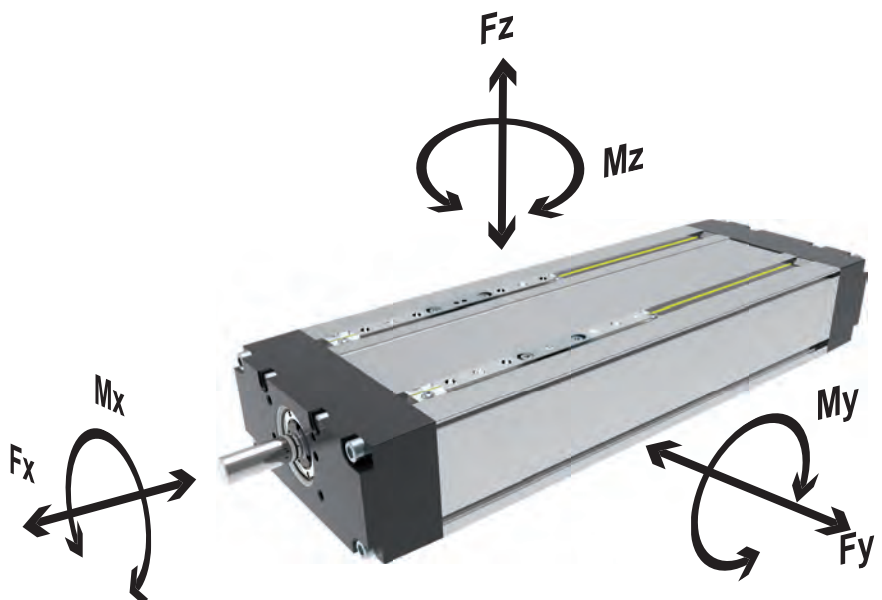

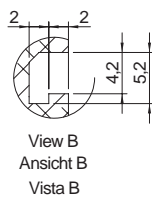
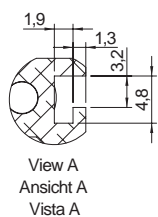
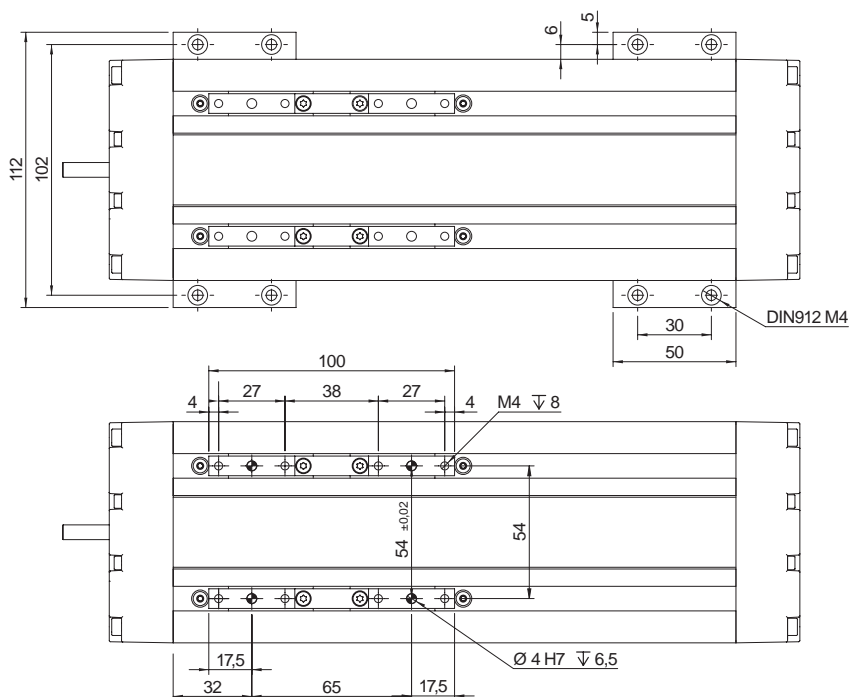
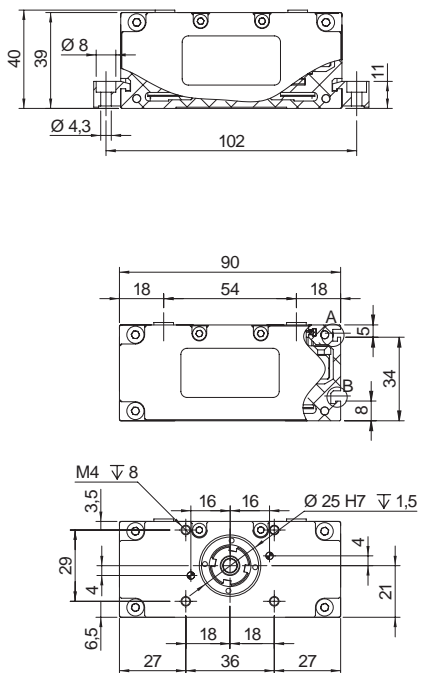

Double Carriage  
Tandem-Wagen  
Doppio Carrello

Stroke + 181  
Hub + 181  
Corsa + 181

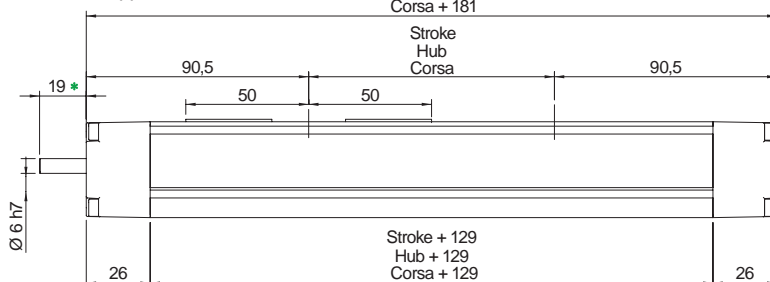

Single Carriage  
Uno-Wagen  
Carrello Singolo

Stroke + 116  
Hub + 116  
Corsa + 116

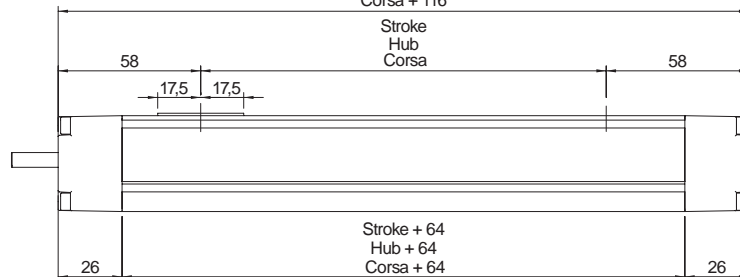

\* Measure likely to change according to customer request  
Messen sich wahrscheinlich ändern nach Kundenwunsch  
Misura suscettibile di modifica su richiesta del cliente

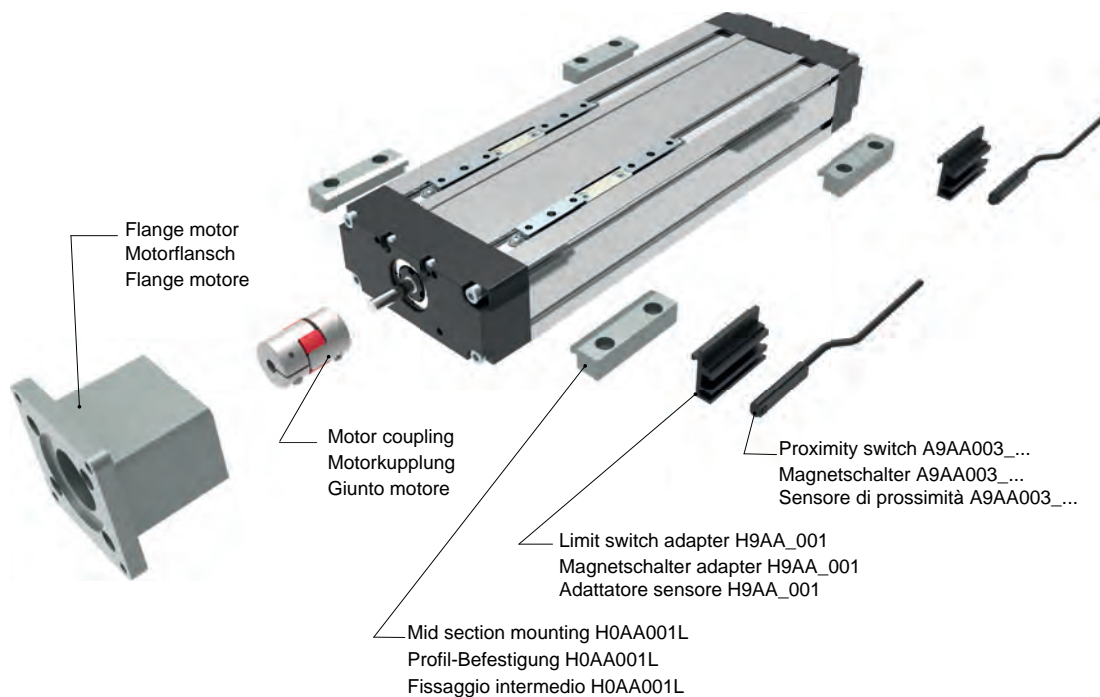

**ORDERING INFORMATION** | Bestallangaben Baureihe | Codici per l'ordinazione

<sup>1</sup>Proximity switch A9AA003\_... | <sup>1</sup>Magnetschalter A9AA003\_... | <sup>1</sup>Sensore di prossimità A9AA003\_...

Part nr.   Ident nr.   Cod.	Cable   Kabel   Cavo	Output   Ausgangsfunktion   Uscita
A9AA003_01	with 2 mt cable   mit 2 mt kabel   con cavo 2 mt	PNP
A9AA003_02	with 2 mt cable   mit 2 mt kabel   con cavo 2 mt	NPN
A9AA003_03	200 mm with M8 plug in   mit 200 mm kabel und M8 stecker   200 mm conn. M8	PNP
A9AA003_04	200 mm with M8 plug in   mit 200 mm kabel und M8 stecker   200 mm conn. M8	NPN
A9AA003_NC	with 2 mt cable   mit 2 mt kabel   con cavo 2 mt	NC

**MUK40-1-0500-12 05-R A**

**Shaft** | Versionen Antriebeswelle | Versione Albero

A: Without key shaft | Ohne Passfeder | Senza chiavetta  
B: With key shaft | Mit Passfeder | Con sede chiavetta

**Series MUK**  
Serie MUK  
Serie MUK

**Size 40x90**  
Baugröße 40x90  
Grandezza 40x90

**N. Carriages 1-2**  
Anzahl Wagen 1-2  
Numero carrelli 1-2

**Stroke mm**  
Hub mm  
Corsa mm

**Screw diam.**  
Durchmesser Spindel  
Dim. Vite Ø12 mm

**Screw pitch**  
Spindelsteigung  
Passo vite  
05 = 5 mm  
10 = 10 mm

**Screw type** | Spindeltyp | Vite tipo

R: Rolled screw with ball recirculating  
Kugelrollspindel | Rullata a ricircolo di sfere  
T: Trapezoidal screw | Trapez spindel | Vite trapezia  
G: Grounded | Kugelgewinde | Vite rettificata



**Screw driven guided linear unit**

Linearantrieb mit Rundspindel und integrierter Kugelumlauführung

Attuatori lineari a vite e guida a ricircolo di sfere

	Carriages Laufwagen Carrelli	Max stroke Max Hub Corsa max	Min stroke Min Hub Corsa min	Pitch Steigung Passo vite	Ø screw** Ø gewinde** Ø vite**	Base weight Grundmasse Peso base	Add for 100 mm Masse pro 100 mm Hub Peso ogni 100 mm	Inertia moment Ix Flächenträgheitsmoment Momento d'inerzia Ix	Inertia moment Iy Flächenträgheitsmoment Momento d'inerzia Iy
		mm	mm	mm	mm	kg	kg	cm <sup>4</sup>	cm <sup>4</sup>
MUK50-1	1	1500	--	5	16	1,6	0,55	30	209
				10					
				16					
MUK50-2	2	1500	--	5	16	2,8	0,55	30	209
				10					
				16					

	Pitch Steigung Passo vite	Max Fx*	Max Fy*	Max Fz*	Max Mx*	Max My*	Max Mz*
		N	N	N	Nm	Nm	Nm
MUK50-1	5	1850	4500	4500	325	210	210
	10	1420					
	16	1025					
MUK50-2	5	1850	9750	9750	600	800	800
	10	1420					
	16	1025					

\* The moments and the loads above are max. values. For any further information, please contact our technical department.

\* Die angegebenen Momente und Belastungen sind max. Werte, die nicht überschritten werden sollen. Für weitere Informationen wenden Sie sich bitte an unser Konstruktionsbüro.

\* I carichi e i momenti indicati sono massimi consigliati, per ulteriori informazioni consultare il ns ufficio tecnico.

$$\frac{F_{yA}}{F_y} + \frac{F_{zA}}{F_z} + \frac{M_{xA}}{M_x} + \frac{M_{yA}}{M_y} + \frac{M_{zA}}{M_z} \leq 1$$

\*\* Different types of screws are available, rolled or ground with different tolerances and trapezoidal screws.

\*\* Verschiedene Spindelvarianten sind verfügbar. Kugelrollspindeln geschliffen in verschiedenen Genauigkeitsklassen sowie Trapezspindeln.

\*\* Tipologie di viti disponibili: rullate, rettificate con diversi classi di precisione e trapezoidali.

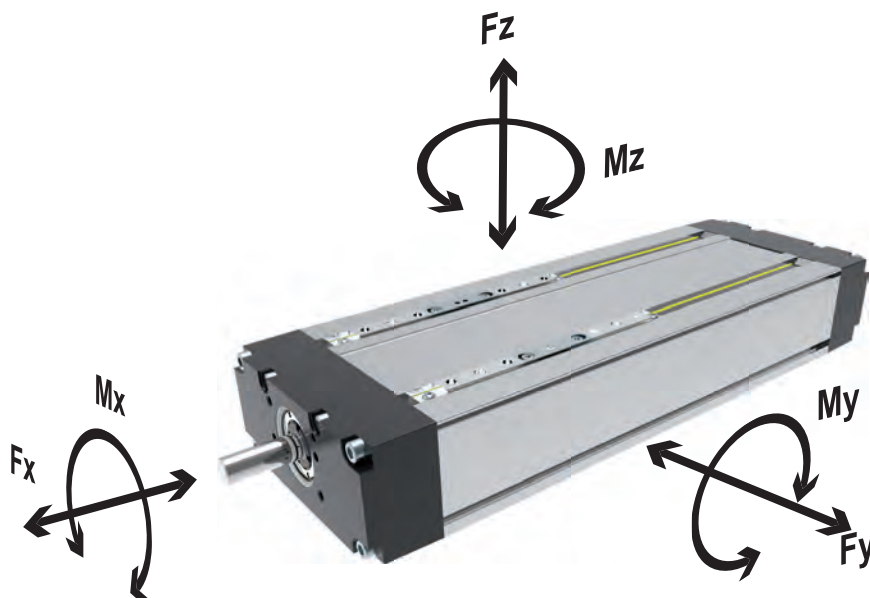

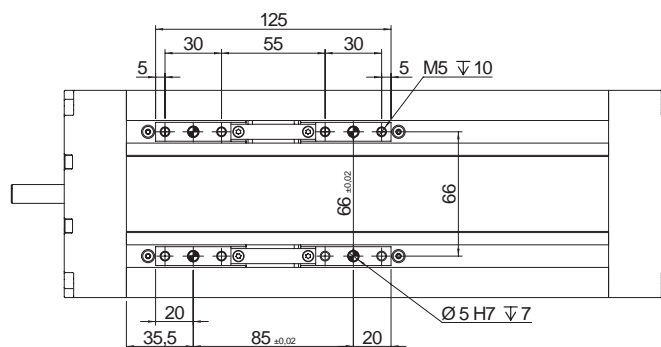
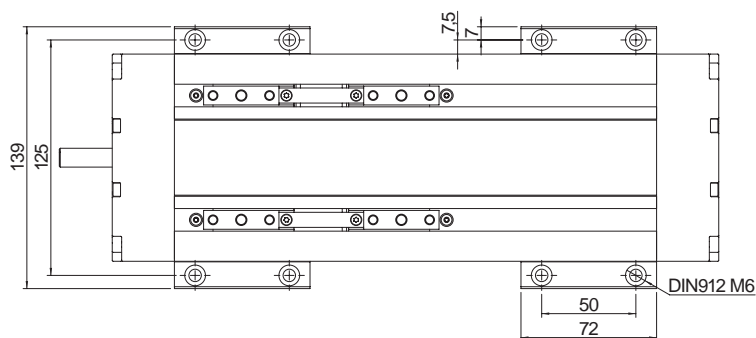
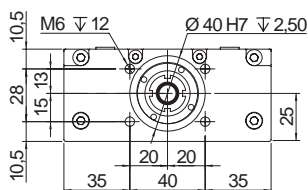
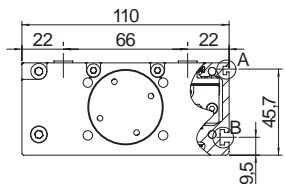
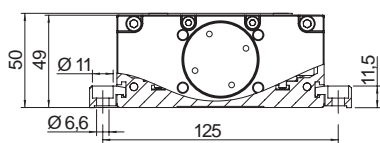

Double Carriage  
Tandem-Wagen  
Doppio Carrello

Stroke + 222  
Hub + 222  
Corsa + 222

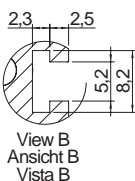
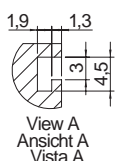
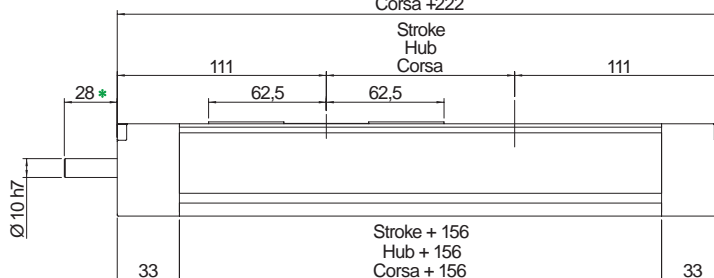

Single Carriage  
Uno-Wagen  
Carrello Singolo

Stroke + 137  
Hub + 137  
Corsa + 137

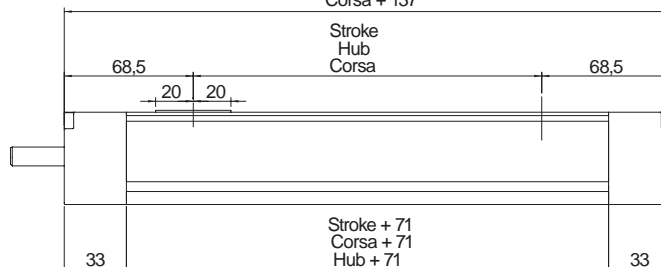

Measure likely to change according to customer request  
Messen sich wahrscheinlich ändern nach Kundenwunsch  
Misura suscettibile di modifica su richiesta del cliente



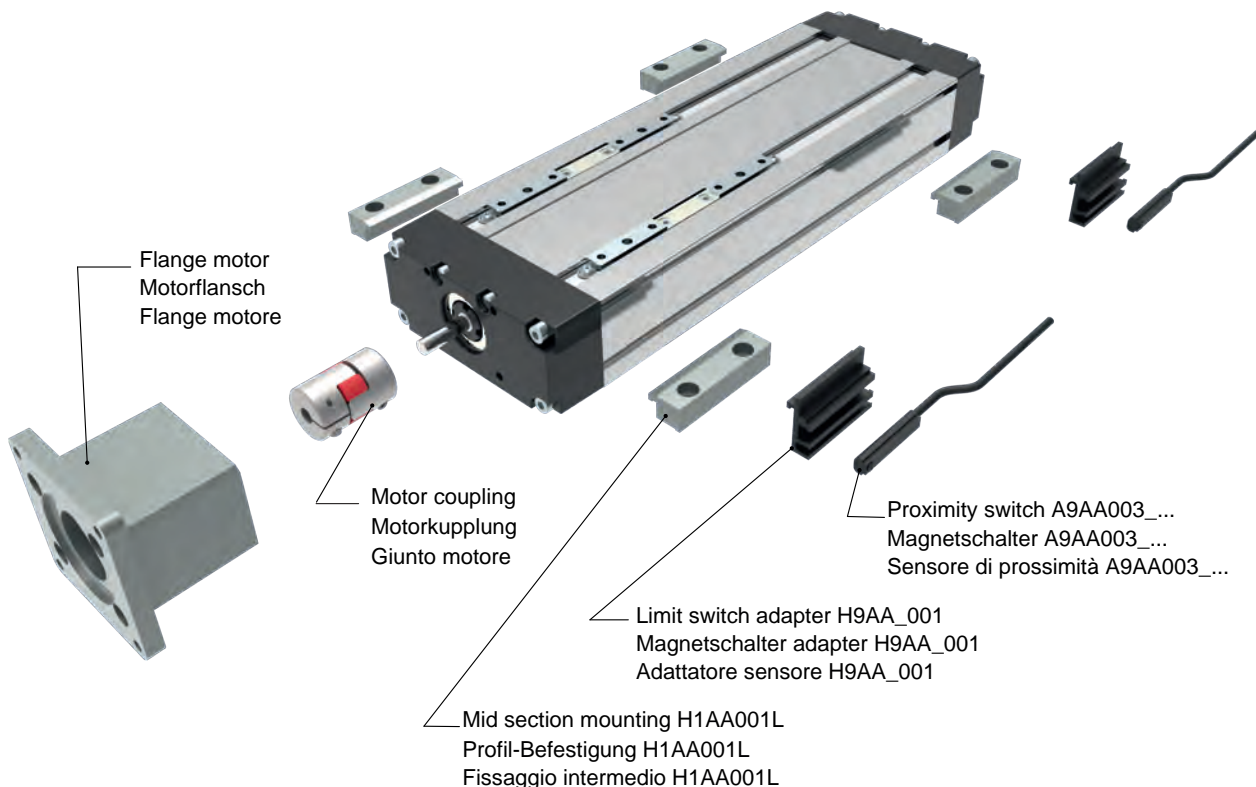

**ORDERING INFORMATION** | Bestallangaben Baureihe | Codici per l'ordinazione

<sup>1</sup>Proximity switch A9AA003\_... | <sup>1</sup>Magnetschalter A9AA003\_... | <sup>1</sup>Sensore di prossimità A9AA003\_...

Part nr.   Ident nr.   Cod.	Cable   Kabel   Cavo	Output   Ausgangfunktion   Uscita
A9AA003_01	with 2 mt cable   mit 2 mt kabel   con cavo 2 mt	PNP
A9AA003_02	with 2 mt cable   mit 2 mt kabel   con cavo 2 mt	NPN
A9AA003_03	200 mm with M8 plug in   mit 200 mm kabel und M8 stecker   200 mm conn. M8	PNP
A9AA003_04	200 mm with M8 plug in   mit 200 mm kabel und M8 stecker   200 mm conn. M8	NPN
A9AA003_NC	with 2 mt cable   mit 2 mt kabel   con cavo 2 mt	NC

**MUK50 -1 -0500 -16 05 -R A**

- Serie MUK**  
Serie MUK  
Serie MUK
- Size 50x110**  
Baugröße 50x110  
Grandezza 50x110
- N. Carriages 1-2**  
Anzahl Wagen 1-2  
Numero carrelli 1-2
- Stroke mm**  
Hub mm  
Corsa mm
- Screw diam.**  
Durchmesser Spindel  
Diam. Vite Ø16 mm
- Screw pitch**  
Spindelsteigung  
Passo vite  
05 = 5 mm  
10 = 10 mm  
16 = 16 mm
- Shaft** | Versionen Antriebeswelle | Versione Albero  
A: Without key shaft | Ohne Passfeder | Senza chiavetta  
B: With key shaft | Mit Passfeder | Con sede chiavetta
- Screw type** | Spindeltyp | Vite tipo  
R: Rolled screw with ball recirculating  
Kugelrollspindel | Rullata a ricircolo di sfere  
T: Trapezoidal screw | Trapez spindel | Vite trapezia  
G: Grounded | Kugelgewinde | Vite rettificata

**Screw driven guided linear unit**

Linearantrieb mit Rundspindel und integrierter Kugelumlaufführung  
 Attuatori lineari a vite e guida a ricircolo di sfere

	Carriages Laufwagen Carrelli	Max stroke Max Hub Corsa max	Min stroke Min Hub Corsa min	Pitch Steigung Passo vite	Ø screw** Ø gewinde** Ø vite**	Base weight Grundmasse Peso base	Add for 100 mm Masse pro 100 mm Hub Peso ogni 100 mm	Inertia moment Ix Flächenträgheitsmoment Momento d'inerzia Ix	Inertia moment Iy Flächenträgheitsmoment Momento d'inerzia Iy
		mm	mm	mm	mm	kg	kg	cm <sup>4</sup>	cm <sup>4</sup>
MUK65-1	1	1500	--	5	20	2,8	0,75	90	687
				10					
				20					
MUK65-2	2	1500	--	5	20	4,1	0,75	90	687
				10					
				20					

	Pitch Steigung Passo vite	Max Fx*	Max Fy*	Max Fz*	Max Mx*	Max My*	Max Mz*
		N	N	N	Nm	Nm	Nm
MUK65-1	5	3597	8500	8500	550	330	330
	10	2996					
	16	1798					
MUK65-2	5	3597	11200	11200	950	1150	1150
	10	2996					
	16	1798					

\* The moments and the loads above are max. values. For any further information, please contact our technical department.

\* Die angegebenen Momente und Belastungen sind max. Werte, die nicht überschritten werden sollen. Für weitere Informationen wenden Sie sich bitte an unser Konstruktionsbüro.

\* I carichi e i momenti indicati sono massimi consigliati, per ulteriori informazioni consultare il ns ufficio tecnico.

$$\frac{F_{yA}}{F_y} + \frac{F_{zA}}{F_z} + \frac{M_{xA}}{M_x} + \frac{M_{yA}}{M_y} + \frac{M_{zA}}{M_z} \leq 1$$

\*\* Different types of screws are available, rolled or ground with different tolerances and trapezoidal screws.

\*\* Verschiedene Spindelvarianten sind verfügbar. Kugelrollspindeln geschliffen in verschiedenen Genauigkeitsklassen sowie Trapezspindeln.

\*\* Tipologie di viti disponibili: rullate, rettificate con diversi classi di precisione e trapezoidali.

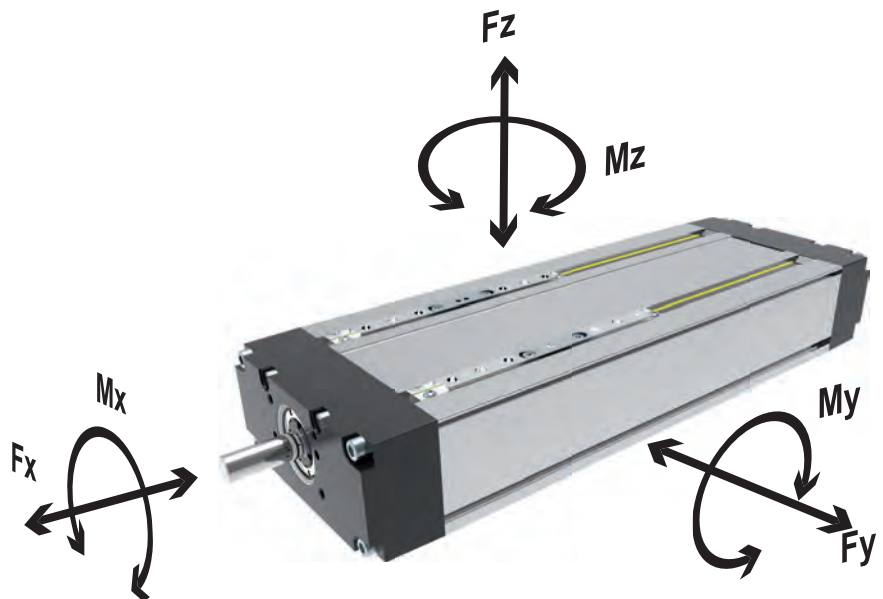



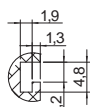
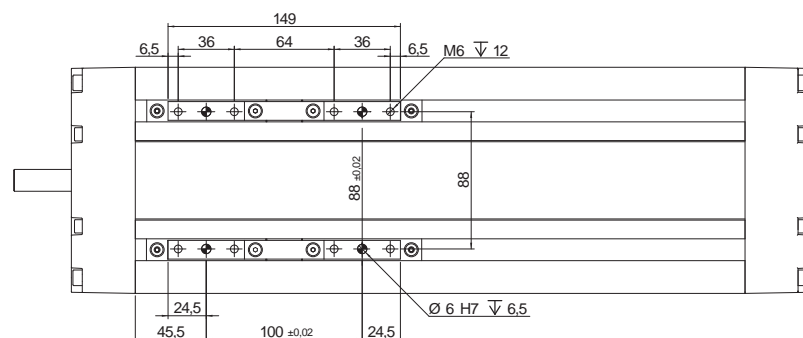
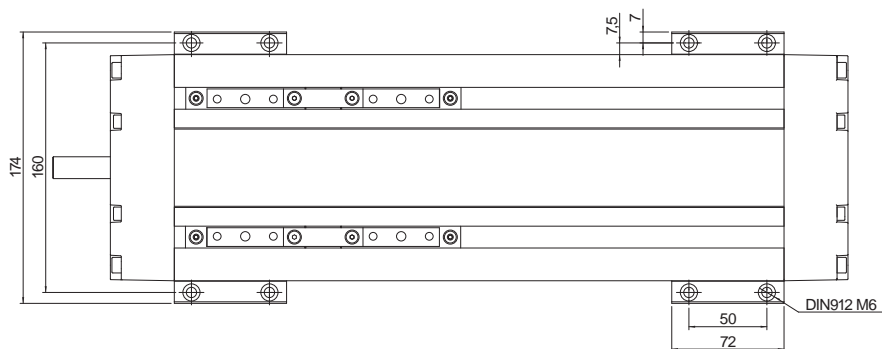
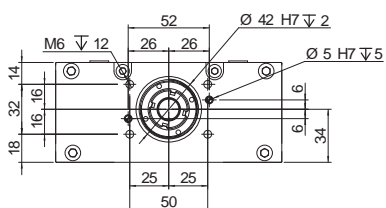
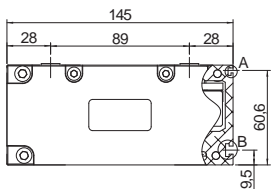
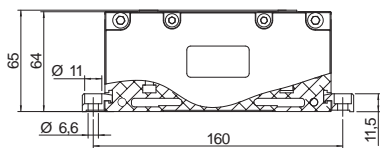

View A  
Ansicht A  
Vista A

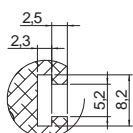

View B  
Ansicht B  
Vista B

Double Carriage  
Tandem-Wagen  
Doppio Carrello

Stroke + 273  
Hub + 273  
Corsa + 273

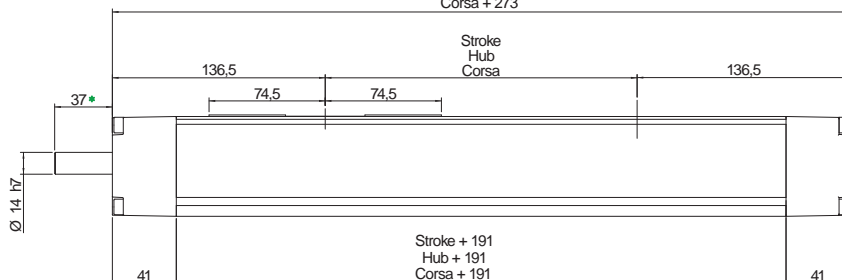

Single Carriage  
Uno-Wagen  
Carrello Singolo

Stroke + 173  
Hub + 173  
Corsa + 173

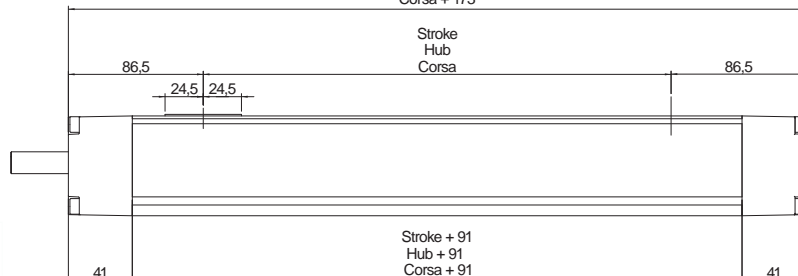

Measure likely to change according to customer request  
Messen sich wahrscheinlich ändern nach Kundenwunsch  
Misura suscettibile di modifica su richiesta del cliente

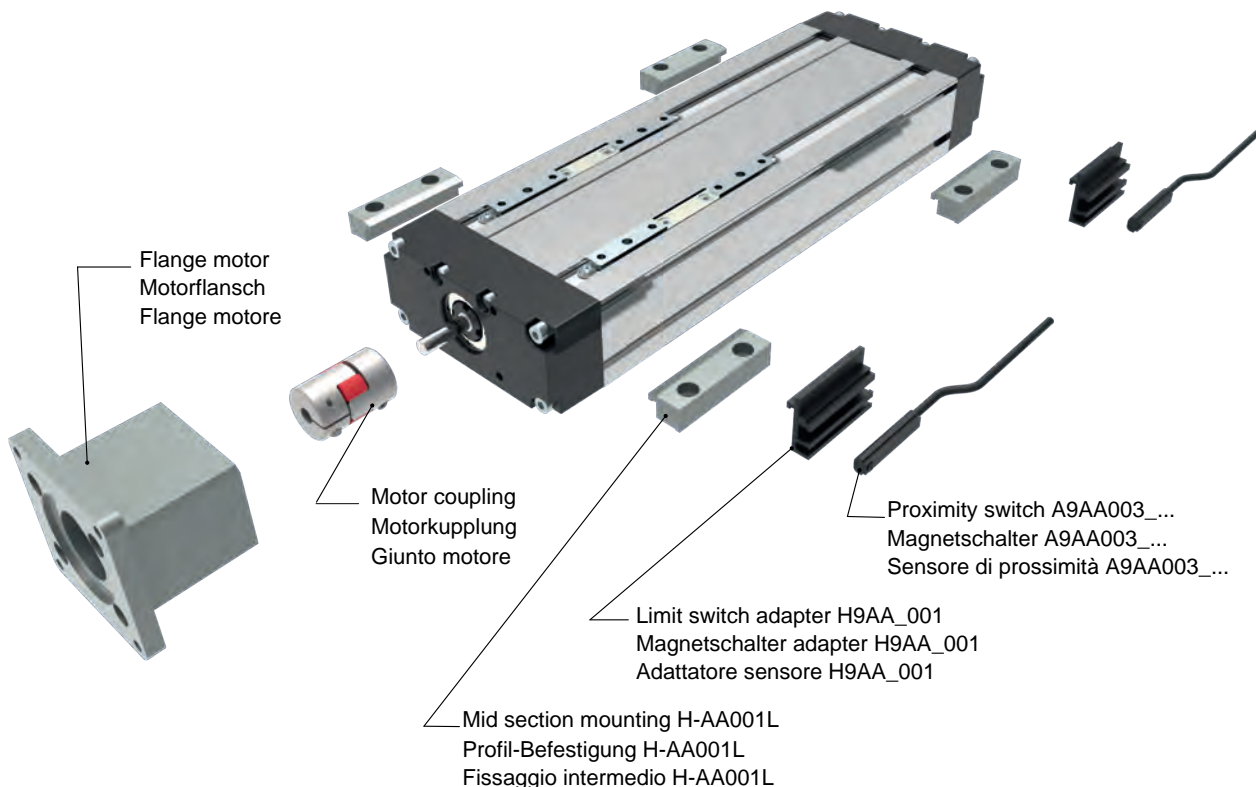

**ORDERING INFORMATION** | Bestallangaben Baureihe | Codici per l'ordinazione

<sup>1</sup>Proximity switch A9AA003\_... | <sup>1</sup>Magnetschalter A9AA003\_... | <sup>1</sup>Sensore di prossimità A9AA003\_...

Part nr.   Ident nr.   Cod.	Cable   Kabel   Cavo	Output   Ausgangfunktion   Uscita
A9AA003_01	with 2 mt cable   mit 2 mt kabel   con cavo 2 mt	PNP
A9AA003_02	with 2 mt cable   mit 2 mt kabel   con cavo 2 mt	NPN
A9AA003_03	200 mm with M8 plug in   mit 200 mm kabel und M8 stecker   200 mm conn. M8	PNP
A9AA003_04	200 mm with M8 plug in   mit 200 mm kabel und M8 stecker   200 mm conn. M8	NPN
A9AA003_NC	with 2 mt cable   mit 2 mt kabel   con cavo 2 mt	NC

**MUK65 -1 -0500 -20 05 -R A**

**Serie MUK**  
Serie MUK  
Serie MUK

**Size 65x145**  
Baugröße 65x145  
Grandezza 65x145

**N. Carriages 1-2**  
Anzahl Wagen 1-2  
Numero carrelli 1-2

**Stroke mm**  
Hub mm  
Corsa mm

**Screw diam.**  
Durchmesser Spindel  
Diam. Vite Ø20 mm

**Screw pitch**  
Spindelsteigung  
Passo vite  
05 = 5 mm  
10 = 10 mm  
20 = 20 mm

**Shaft** | Versionen Antriebeswelle | Versione Albero

A: Without key shaft | Ohne Passfeder | Senza chiavetta  
B: With key shaft | Mit Passfeder | Con sede chiavetta

**Screw type** | Spindeltyp | Vite tipo

R: Rolled screw with ball recirculating  
Kugelrollspindel | Rullata a ricircolo di sfere  
T: Trapezoidal screw | Trapez spindel | Vite trapezia  
G: Grounded | Kugelgewinde | Vite rettificata



**Screw driven guided linear unit**

Linearantrieb mit Rundspindel und integrierter Kugelumlaufführung  
 Attuatori lineari a vite e guida a ricircolo di sfere

**TECHNICAL DATA | TECHNISCHE DATEN | DATI TECNICI**

Size - Baugröße - Taglia			55x60		
Max. speed* - Max. Geschwindigkeit* - Velocità max*	m/s		1		
Max. stroke length - Max. Hub - Corsa max	mm	1000	1250	1500	
Min. stroke length - Min. Hub - Corsa min	mm	100	100	100	
Pitch - Spindelsteigung - Passo vite	mm	5	10	16	
Screw diameter - Spindeldurchmesser - Diametro vite	mm	16			
Base weight - Gewicht bei 0mm Hub - Peso corsa 0 mm	Kg	3,2			
Add for 100 mm of stroke - Gewicht bei 100mm Hub - Peso corsa 100 mm	Kg	0,6			
Max. load** - Max. Belastung ** - Carico max**	Fx	N	1850	1420	1025
	Fy	N	4500	4500	4500
	Fz	N	4500	4500	4500
Moments* - Max. Belastungsmoment* - Momenti max*	Mx	Nm	395		
	My	Nm	480		
	Mz	Nm	480		
Inertia moment Aluminum profile - Flächenträgheitmoment - Momento d'inerzia profilo	Ix	cm <sup>4</sup>	47,3		
Inertia moment Aluminum profile - Flächenträgheitmoment - Momento d'inerzia profilo	Iy	cm <sup>4</sup>	49,5		
Repeatability - Wiederholgenauigkeit - Ripetibilità	mm	± 0,02			
Screw class - Klasse Kugelgewinde - Classe vite**	T7				
No load torque - Leerlaufmoment - Coppia resistente	Nm	0,2	0,15		

\* It depends from stroke and the spindle pitch  
 \* In Abhängigkeit von Hub und Spindelsteigung  
 \* Valore indicativo, dipende dalla corsa e dal passo vite

\*\* Max values for dynamic conditions. Please refer to the following formula when combined loads are applied.

\*\* Für die Ermittlung der maximalen dynamischen Tragzahlen bei kombinierten Kraftangriffspunkten, nutzen Sie bitte die nebenstehende Berechnungsformel.

\*\* Valori massimi in condizioni dinamiche. In presenza di carichi combinati riferirsi alla formula per la verifica dei carichi massimi da applicare.

$$\frac{F_{yA}}{F_y} + \frac{F_{zA}}{F_z} + \frac{M_{xA}}{M_x} + \frac{M_{yA}}{M_y} + \frac{M_{zA}}{M_z} \leq 1$$

The A letters show the calculated value.  
 Der A Parameter entspricht dem errechneten Wert.  
 La lettera A indica i valori complessivi calcolati

\*\*\* Different types of screws are available, rolled or ground with different tolerances and trapezoidal screws.

\*\*\* Verschiedene Spindelvarianten sind verfügbar. Kugellrollspindeln geschliffen in verschiedenen Genauigkeitsklassen sowie Trapezspindeln.

\*\*\* Tipologie di viti disponibili: rullate, rettificata con diversi classi di precisione e trapezoidali.

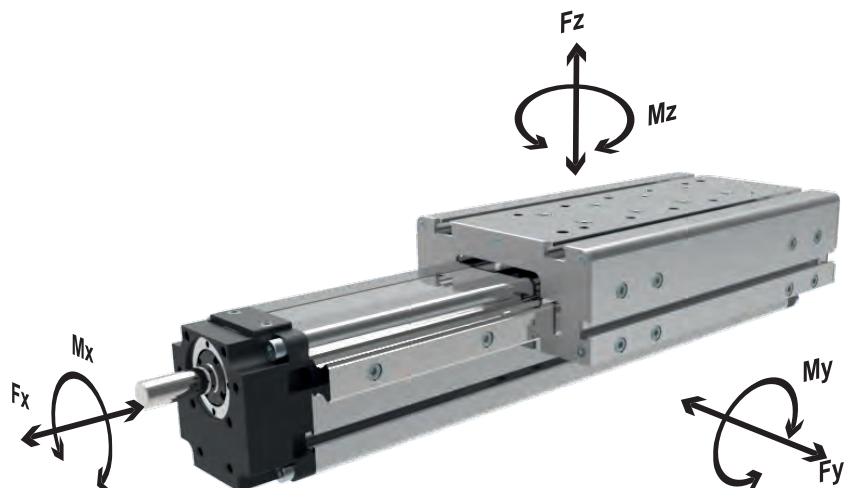

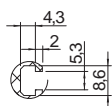
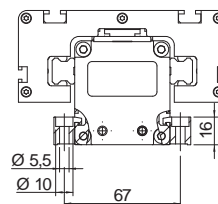
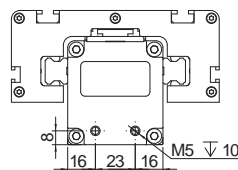
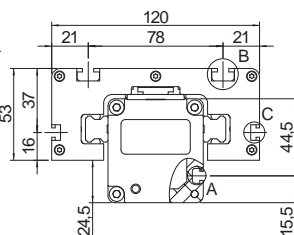
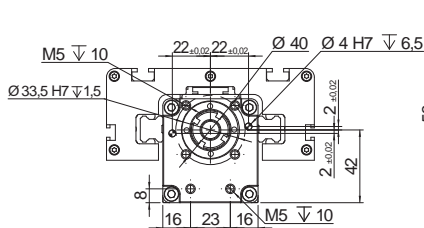
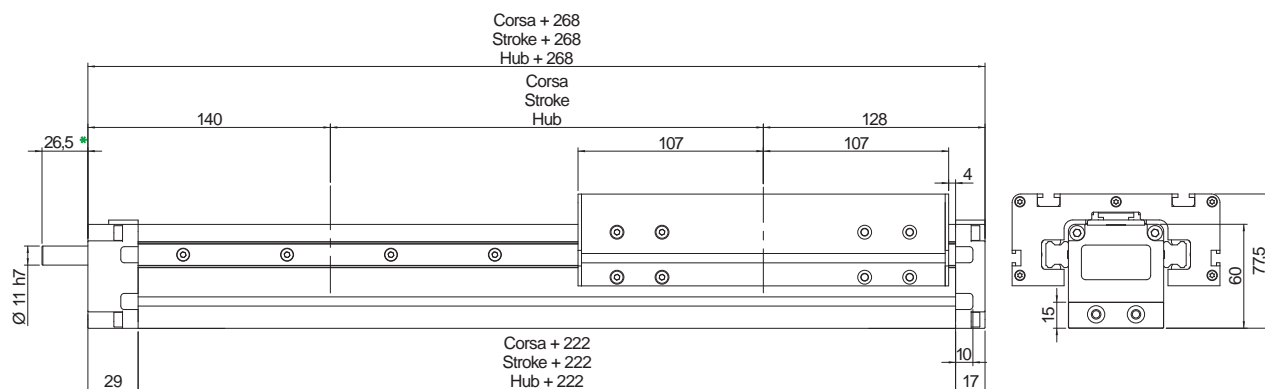
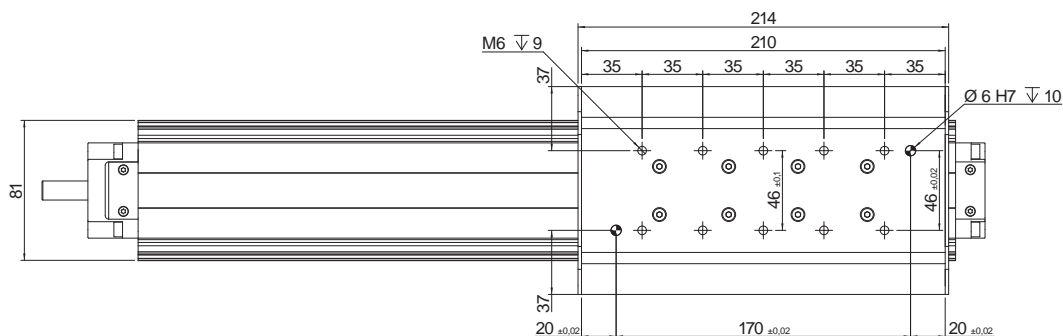
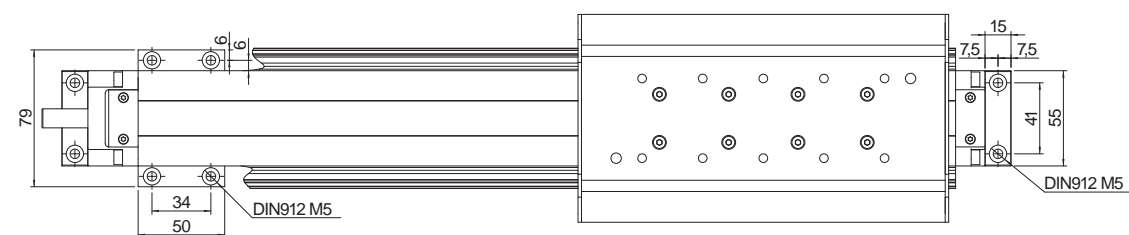

Vista A  
View A  
Ansicht A

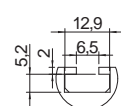

Vista B  
View B  
Ansicht B

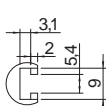

Vista C  
View C  
Ansicht C

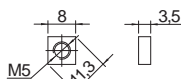

Codice: DQM05  
Part n: DQM05  
Bestellcode: DQM05

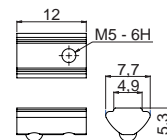

Codice: DTM05-M5  
Part.n: DTM05-M5  
Bestellcode: DTM05-M5

Misura suscettibile di modifica su richiesta del cliente  
Measure likely to change according to customer request  
Messen sich wahrscheinlich ändern nach Kundenwunsch

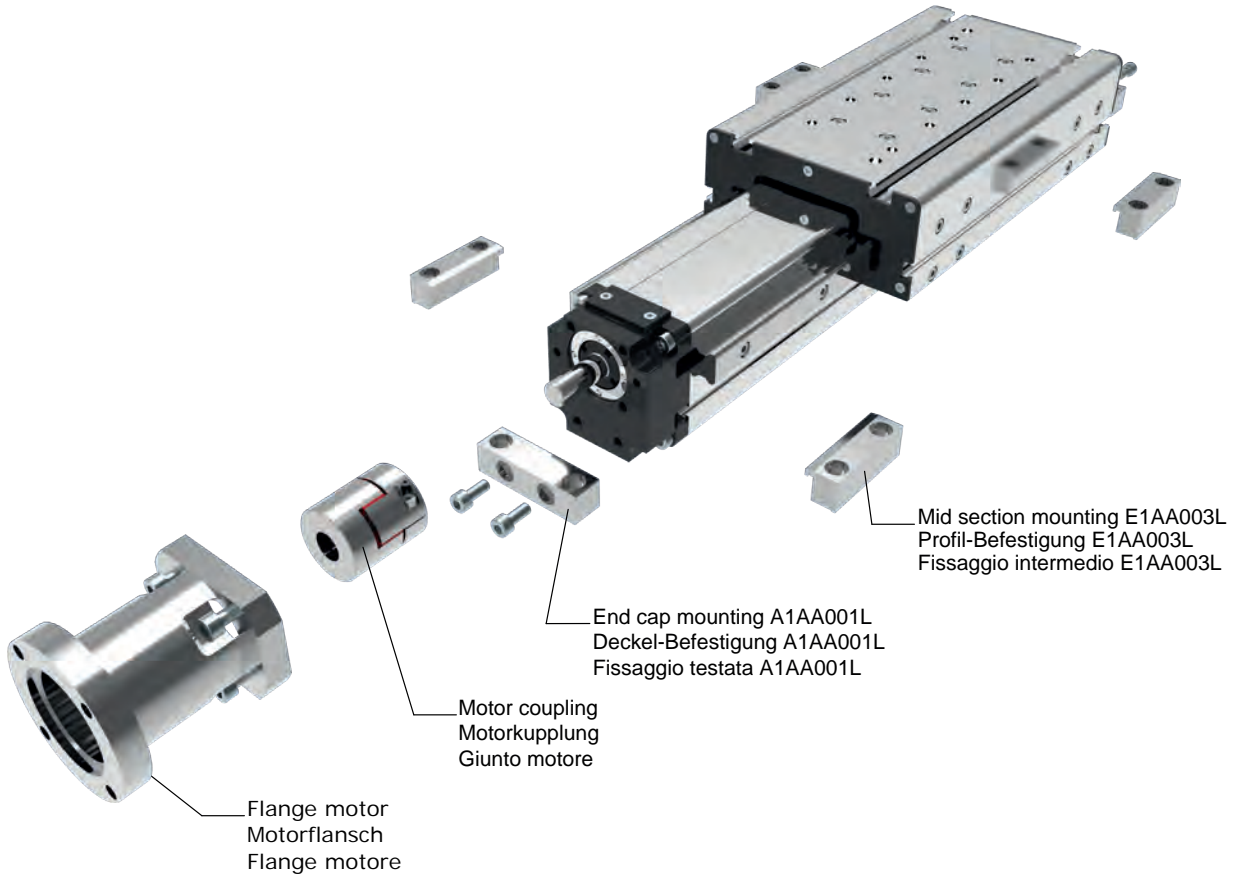

**ORDERING INFORMATION** | Bestallangaben Baureihe | Codici per l'ordinazione

<sup>1</sup>Proximity switch A9AA003\_... | <sup>1</sup>Magnetschalter A9AA003\_... | <sup>1</sup>Sensore di prossimità A9AA003\_...

Part nr.   Ident nr.   Cod.	Cable   Kabel   Cavo	Output   Ausgangfunktion   Uscita
A9AA003_01	with 2 mt cable   mit 2 mt kabel   con cavo 2 mt	PNP
A9AA003_02	with 2 mt cable   mit 2 mt kabel   con cavo 2 mt	NPN
A9AA003_03	200 mm with M8 plug in   mit 200 mm kabel und M8 stecker   200 mm conn. M8	PNP
A9AA003_04	200 mm with M8 plug in   mit 200 mm kabel und M8 stecker   200 mm conn. M8	NPN
A9AA003_NC	with 2 mt cable   mit 2 mt kabel   con cavo 2 mt	NC

**MVS55-0500-16 05-R A**

**Series MVS**  
Serie MVS  
Serie MVS

**Size 55x60**  
Baugröße 55x60  
Grandezza 55x60

**Stroke mm**  
Hub mm  
Corsa mm

**Screw diam.**  
Durchmesser Spindel  
Dim. Vite Ø16 mm

**Screw pitch**  
Spindelsteigung  
Passo vite  
05 = 5 mm  
10 = 10 mm  
16 = 16 mm

**Shaft** | Versionen Antriebeswelle | Versione Albero

A: Without key shaft | Ohne Passfeder | Senza chiavetta  
B: With key shaft | Mit Passfeder | Con sede chiavetta

**Screw type** | Spindeltyp | Vite tipo

R: Rolled screw with ball recirculating  
Kugelrollspindel | Rullata a ricircolo di sfere  
T: Trapezoidal screw | Trapez spindel | Vite trapezia  
G: Grounded | Kugelgewinde | Vite rettificata

**Screw driven guided linear unit**

Linearantrieb mit Rundspindel und integrierter Kugelumlauführung  
Attuatori lineari a vite e guida a ricircolo di sfere

**TECHNICAL DATA | TECHNISCHE DATEN | DATI TECNICI**

Size - Baugröße - Taglia			80x85		
Max. speed* - Max. Geschwindigkeit* - Velocità max*	m/s		1,25		
Max. stroke length - Max. Hub - Corsa max	mm	1000	1250	1500	
Min. stroke length - Min. Hub - Corsa min	mm	100	100	100	
Pitch - Spindelsteigung - Passo vite	mm	5	10	20	
Screw diameter - Spindeldurchmesser - Diametro vite	mm	20			
Base weight - Gewicht bei 0mm Hub - Peso corsa 0 mm	Kg	7,5			
Add for 100 mm of stroke - Gewicht bei 100mm Hub - Peso corsa 100 mm	Kg	1,2			
Max. load** - Max. Belastung** - Carico max**	Fx	N	3597	2996	1798
	Fy	N	8500		
	Fz	N	8500		
Moments* - Max. Belastungsmoment* - Momenti max*	Mx	Nm	90		
	My	Nm	500		
	Mz	Nm	500		
Inertia moment Aluminum profile - Flächenträgheitmoment - Momento d'inerzia profilo	Ix	cm <sup>4</sup>	190		
Inertia moment Aluminum profile - Flächenträgheitmoment - Momento d'inerzia profilo	Iy	cm <sup>4</sup>	190,2		
Repeatability - Wiederholgenauigkeit - Ripetibilità	mm	± 0,02			
Screw class - klasse Kugelgewinde - Classe vite**	T7				
No load torque - Leerlaufmoment - Coppia resistente	Nm	0,4	0,3	0,2	

\* It depends from stroke and the spindle pitch  
\* In Abhängigkeit von Hub und Spindelsteigung  
\* Valore indicativo, dipende dalla corsa e dal passo vite

\*\* Max values for dynamic conditions. Please refer to the following formula when combined loads are applied.

\*\* Für die Ermittlung der maximalen dynamischen Tragzahlen bei kombinierten Kraftangriffspunkten, nutzen Sie bitte die nebenstehende Berechnungsformel.

\*\* Valori massimi in condizioni dinamiche. In presenza di carichi combinati riferirsi alla formula per la verifica dei carichi massimi da applicare.

$$\frac{F_{yA}}{F_y} + \frac{F_{zA}}{F_z} + \frac{M_{xA}}{M_x} + \frac{M_{yA}}{M_y} + \frac{M_{zA}}{M_z} \leq 1$$

The A letters show the calculated value.  
Der A Parameter entspricht dem errechneten Wert.  
La lettera A indica i valori complessivi calcolati

\*\*\* Different types of screws are available, rolled or ground with different tolerances and trapezoidal screws.

\*\*\* Verschiedene Spindelvarianten sind verfügbar. Kugelrollspindeln geschliffen in verschiedenen Genauigkeitsklassen sowie Trapezspindeln.

\*\*\* Tipologie di viti disponibili: rullate, rettificata con diversi classi di precisione e trapezoidali.

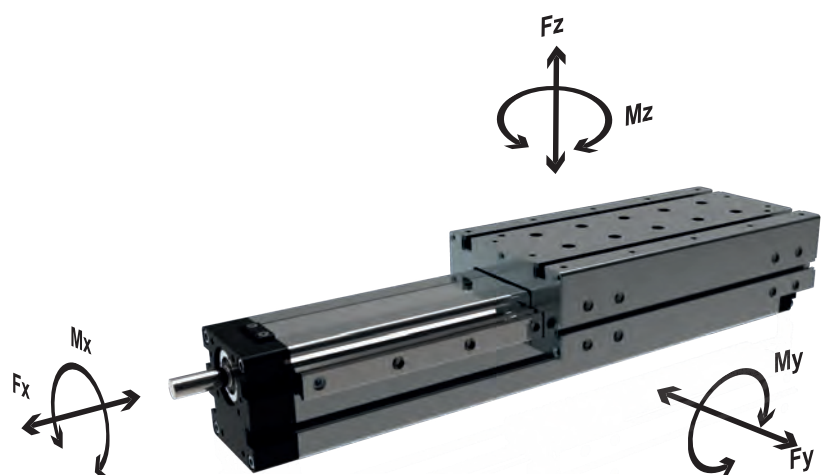



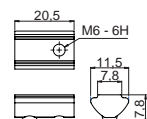
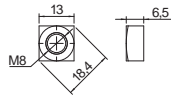
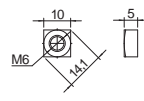
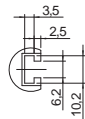
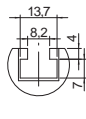
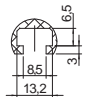
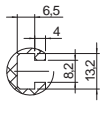
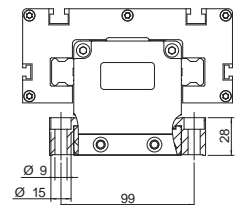
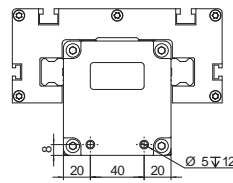
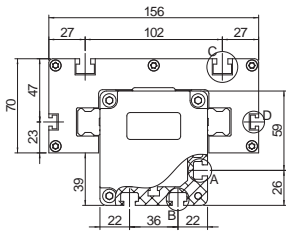
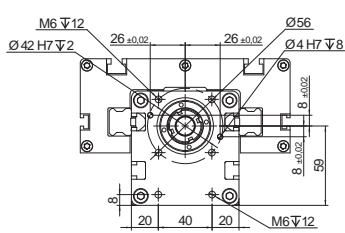
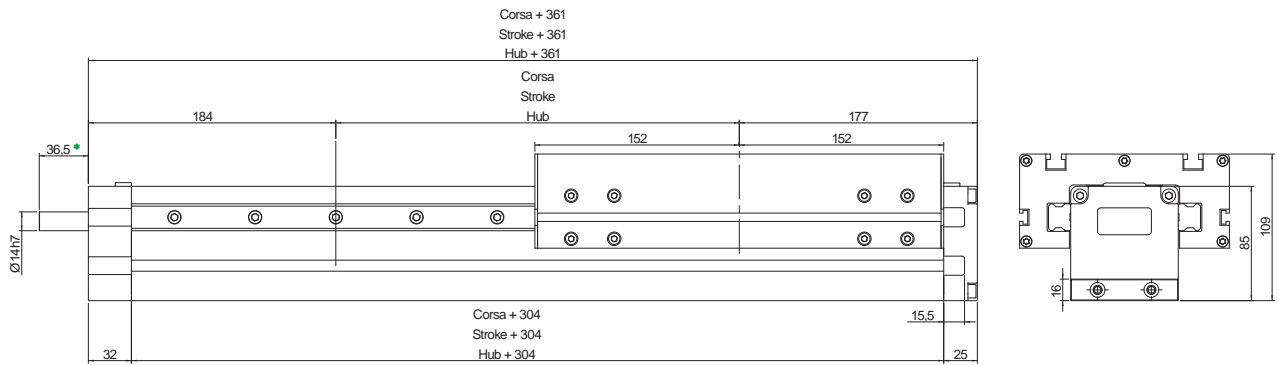
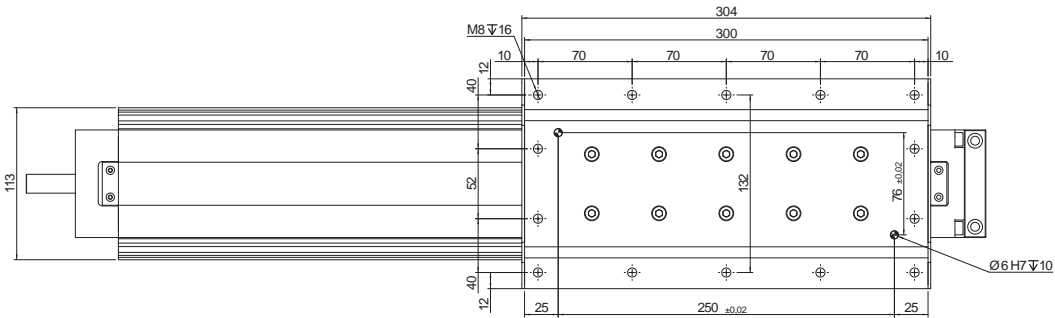
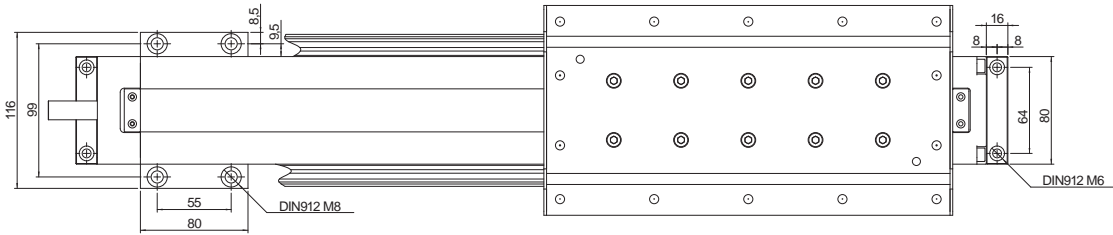

Vista A  
View A  
Ansicht A

Vista B  
View B  
Ansicht B

Vista C  
View C  
Ansicht C

Vista D  
View D  
Ansicht D

Codice: DQM06  
Part n.: DQM06  
Bestellcode: DQM06

Codice: DQM08  
Part n.: DQM08  
Bestellcode: DQM08

Codice: DTM08-M6  
Part n.: DTM08-M6  
Bestellcode: DTM08-M6

Misura suscettibile di modifica su richiesta del cliente  
Measure likely to change according to customer request  
Messen sich wahrscheinlich ändern nach Kundenwunsch

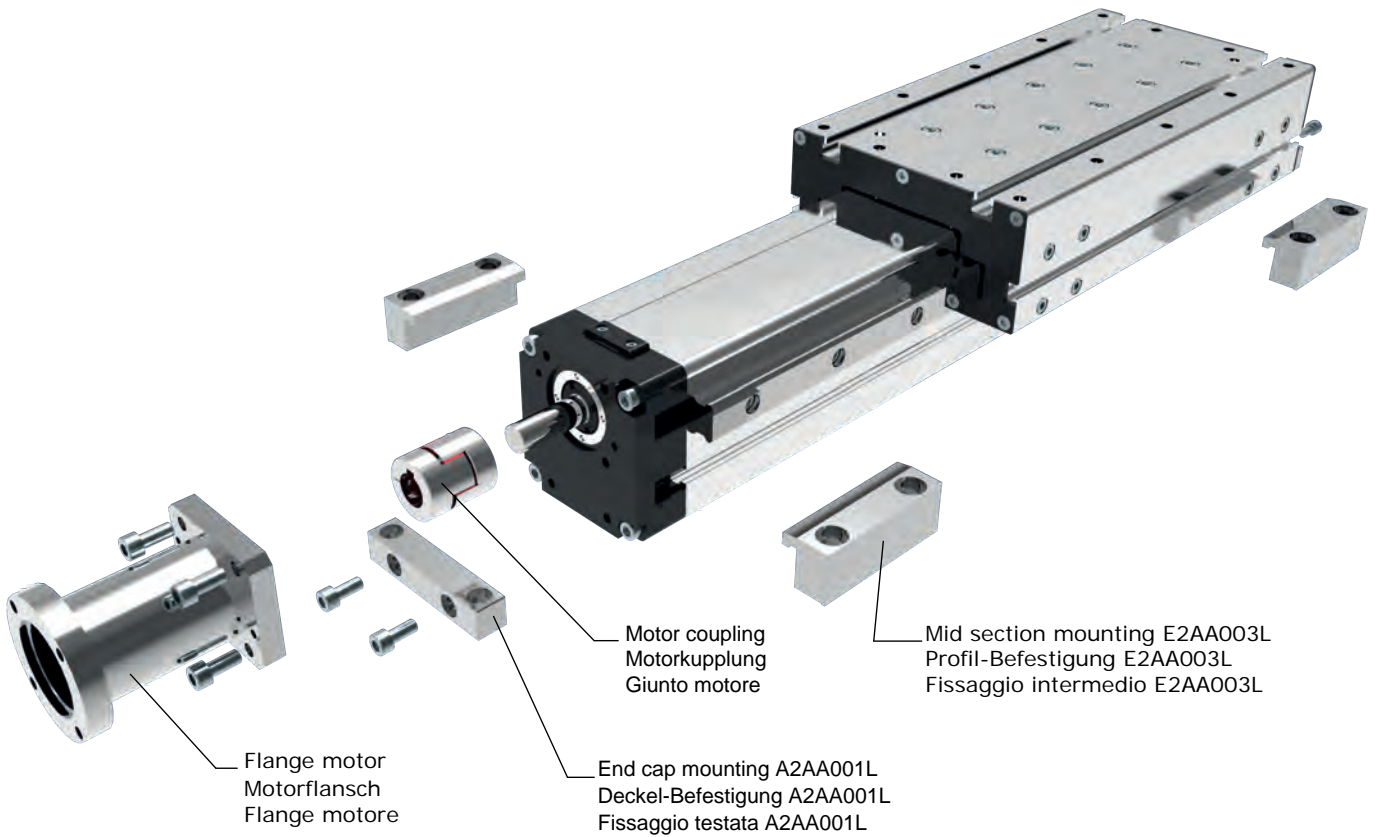

**ORDERING INFORMATION** | Bestallangaben Baureihe | Codici per l'ordinazione

<sup>1</sup>Proximity switch A9AA003\_... | <sup>1</sup>Magnetschalter A9AA003\_... | <sup>1</sup>Sensore di prossimità A9AA003\_...

Part nr.   Ident nr.   Cod.	Cable   Kabel   Cavo	Output   Ausgangfunktion   Uscita
A9AA003_01	with 2 mt cable   mit 2 mt kabel   con cavo 2 mt	PNP
A9AA003_02	with 2 mt cable   mit 2 mt kabel   con cavo 2 mt	NPN
A9AA003_03	200 mm with M8 plug in   mit 200 mm kabel und M8 stecker   200 mm conn. M8	PNP
A9AA003_04	200 mm with M8 plug in   mit 200 mm kabel und M8 stecker   200 mm conn. M8	NPN
A9AA003_NC	with 2 mt cable   mit 2 mt kabel   con cavo 2 mt	NC

**MVS80-0500-20 05-R A**

**Series MVS**  
Serie MVS  
Serie MVS

**Size 80x85**  
Baugröße 80x85  
Grandezza 80x85

**Stroke mm**  
Hub mm  
Corsa mm

**Screw diam.**  
Durchmesser Spindel  
Dim. Vite Ø16 mm

**Screw pitch**  
Spindelsteigung  
Passo vite  
05 = 5 mm  
10 = 10 mm  
20 = 20 mm

**Shaft** | Versionen Antriebswelle | Versione Albero

A: Without key shaft | Ohne Passfeder | Senza chiavetta  
B: With key shaft | Mit Passfeder | Con sede chiavetta

**Screw type** | Spindeltyp | Vite tipo

R: Rolled screw with ball recirculating  
Kugelrollspindel | Rullata a ricircolo di sfere  
T: Trapezoidal screw | Trapez spindel | Vite trapezia  
G: Grounded | Kugelgewinde | Vite rettificata