

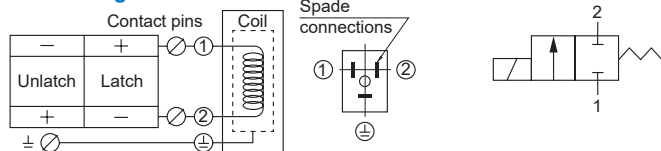

### Circuit diagram



### Features

- Valve open when power on, then power shut off, valve still open. Change to opposite pole, valve close.
- Energy-saving, blocking hazardous fluid.

### Specification

- IP65 waterproof coil.
- Continuous cycle, 100% ED.
- Open: 50~20ms, Close: 10~40ms

### Power consumption

Coil power	2L
DC 6/12V (W)	6.9
DC 24V (W)	6.0

### Dimensions

Model	MUCL	
Code	03	06
Dimension (mm)		
<b>C</b>	51	53
<b>D</b>	18	23
<b>H</b>	58	63
<b>L</b>	25	30
<b>W</b>	25	25
N.W (kg)	0.18	0.23

### Order example

**MUCL - 06 - 1 - T - L - D - DC12 - G**

<b>MODEL</b>	<b>CODE</b>	<b>FIG.</b>	<b>COIL</b>	<b>PLUG</b>	<b>VOLTAGE</b>	<b>PORT THREAD</b>
	03: 1/8 06: 1/4	1,2,3 4,5,6	L: #2L	Blank: DIN D: LED G: 1/2" NPT Y: 2 wires	DC6V DC12V DC24V	Blank: Rc thread G: G thread NPT: NPT thread
			<b>SEAL MAT'L</b>			
			N: NBR J: EPDM V: Viton T: PTFE Z: FFKM			

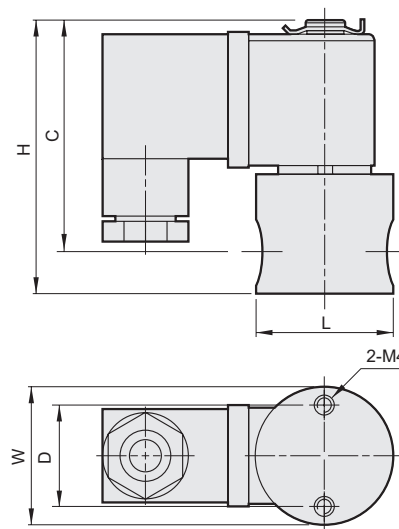

### Specification

Model <b>MUCL</b> : SUS303 Body, For water, air, gas, light oil (below 50cst), vacuum etc. 2/2 way N.C.										
Code (Port)	Fig no.	Seal mat'l	Coil	Orifice mm	Temp. °C			Working press. (0~ bar)	CV	Torr
					N	J,V	T,Z			
03(1/8) 06(1/4)	1	N J V T Z	2L	1.0	-5 ~ 80	-10 ~ 80	-20 ~ 80	15	0.03	10 <sup>-2</sup>
	2			1.3				12	0.05	
	3			1.6				10	0.07	
	4			2.0				6	0.11	10 <sup>-1</sup>
	5			2.5				5	0.18	
	6			3.0				4	0.27	

\* Max. orifice: T-2.5mm

\* PTFE seal has below 300cc/min. slight leakage, not suitable for vacuum.