

Features

- Tube I.D. ϕ 16, 20, 25, 32, 40, 50, 63, 80 mm.
- Opening / closing stroke move than twice the standard (MCHG2).
- Interchangeable with MCHG2 in mounting.
- Magnetic as standard.

Order example

MCHG2L – 16 M

MODEL

TUBE I.D.

M: Magnet

* Magnetic as standard.

16
20
25
32
40
50
63
80

Sensor switch

RT × 1

NUMBER of
AUTO SWITCH

AUTO SWITCH TYPE

perpendicular	in-line		style
RTV	RT	RK	Reed switch
RTNV	RTN	RKN	NPN
RTPV	RTP	RKP	PNP

for ϕ 32~80

for ϕ 16~25

* RT specification, please refer to page 5-14.

Specification

Model	MCHG2L									
Acting type	Double acting									
Tube I.D. (mm)	16	20	25	32	40	50	63	80		
Stroke (mm)	10	10	12	16	20	28	32	40		
Medium	Air									
Operating pressure	0.2~0.6 MPa									
Ambient temperature	-10~+60°C (No freezing)									
Repeatability	\pm 0.01 mm									
Max. operating frequency (c.p.m)	120			60			30			
Lubrication	Cylinder	Not required								
	Lever	Grease (Actuation at)								
Effective gripping force N (lbf) at (0.5 MPa) (*)	External	14(3.1)	25(5.6)	42(9.4)	74(16.6)	118(26.5)	187(42)	335(75)	500(112)	
	Internal	16(3.6)	28(6.3)	47(10.6)	82(18.4)	130(29)	204(46)	359(81)	525(118)	
Weight (g)	100	150	190	373	600	930	1850	2880		

* Open and closed diameter values apply for external gripping of work pieces.

MCHG2L Dimensions $\phi 16 \sim \phi 25$

LONG STROKE TYPE PARALLEL GRIPPER (3-Finger)

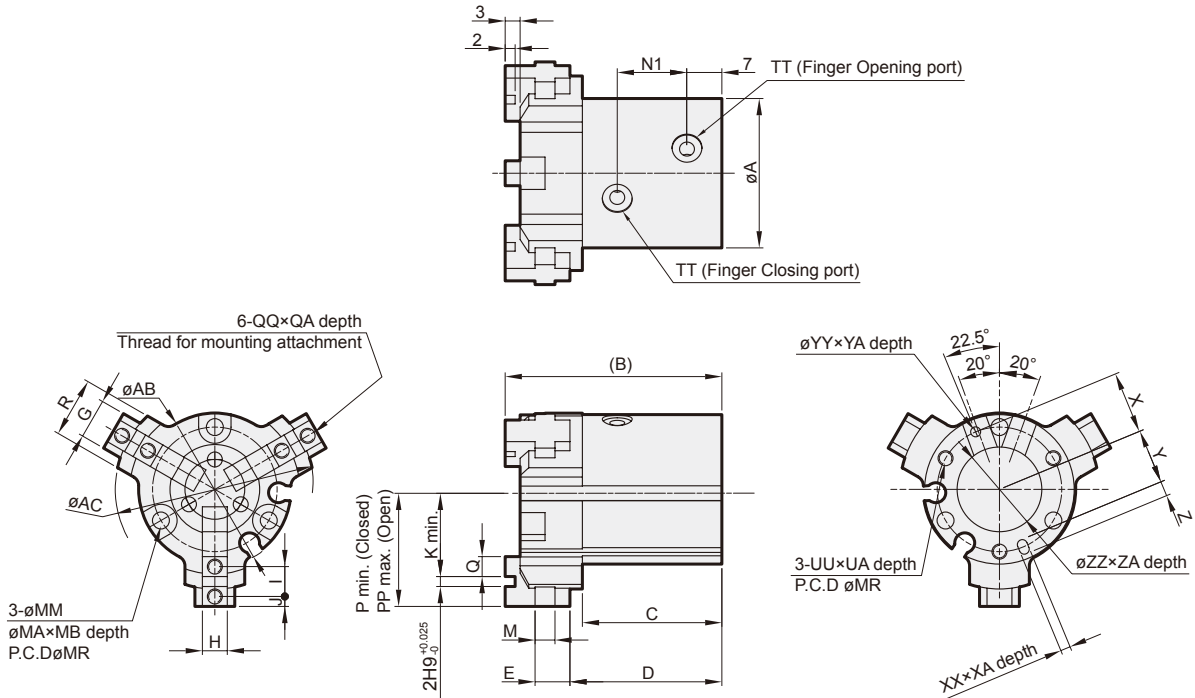

Auto switch mounting groove position (2 places) Mounting hole counter bore dimensions

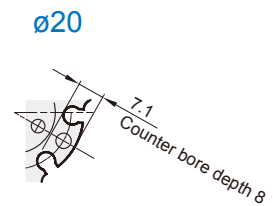
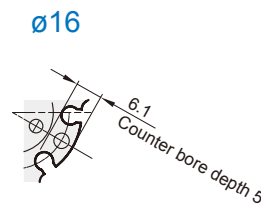
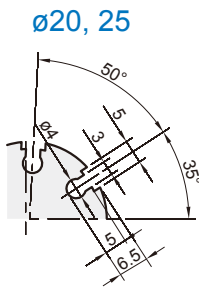
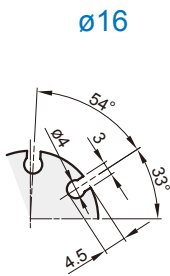

Note. The counter bore configuration differs only for the mounting hole section between the auto switch mounting grooves.

Code Tube I.D.	A	AB	AC	B	C	D	E	G	H	I	J	K	M	MA	MB	MM	MR	N1	P	PP	Q	QA	QQ
16	30	30.6	40	43.5	28	30.5	7	8	5h9 ⁺⁰ _{-0.030}	6	2	12.5	4	6.5	5	3.4	25	14	18.5	23.5	4	5	M3×0.5
20	36	36.6	45	46	29	32	8	11	6h9 ⁺⁰ _{-0.030}	7	2.5	14	4	6.5	8	3.4	29	14	21	26	5	6	M3×0.5
25	42	42.6	52	49	31.5	34.2	7.8	13	6h9 ⁺⁰ _{-0.030}	8	3	16	4.5	8	8	4.5	34	16.5	24	30	6	6	M3×0.5

Code Tube I.D.	R	TT	UA	UU	X	XA	XX	Y	YA	YY	Z	ZA	ZZ
16	12	M3×0.5	1.5	M3×0.5	12.5	2	2H9 ^{+0.025} ₋₀	11	2	2H9 ^{+0.025} ₋₀	3	1.5	17H9 ^{+0.043} ₋₀
20	16	M5×0.8	1.5	M3×0.5	14.5	2	2H9 ^{+0.025} ₋₀	13	3	2H9 ^{+0.025} ₋₀	3	1.5	21H9 ^{+0.052} ₋₀
25	19	M5×0.8	1.5	M4×0.7	17	3	3H9 ^{+0.025} ₋₀	14.5	3	3H9 ^{+0.025} ₋₀	5	1.5	26H9 ^{+0.052} ₋₀

MCHG2L Dimensions $\varnothing 32\sim\varnothing 80$



LONG STROKE TYPE PARALLEL GRIPPER (3-Finger)

mindman

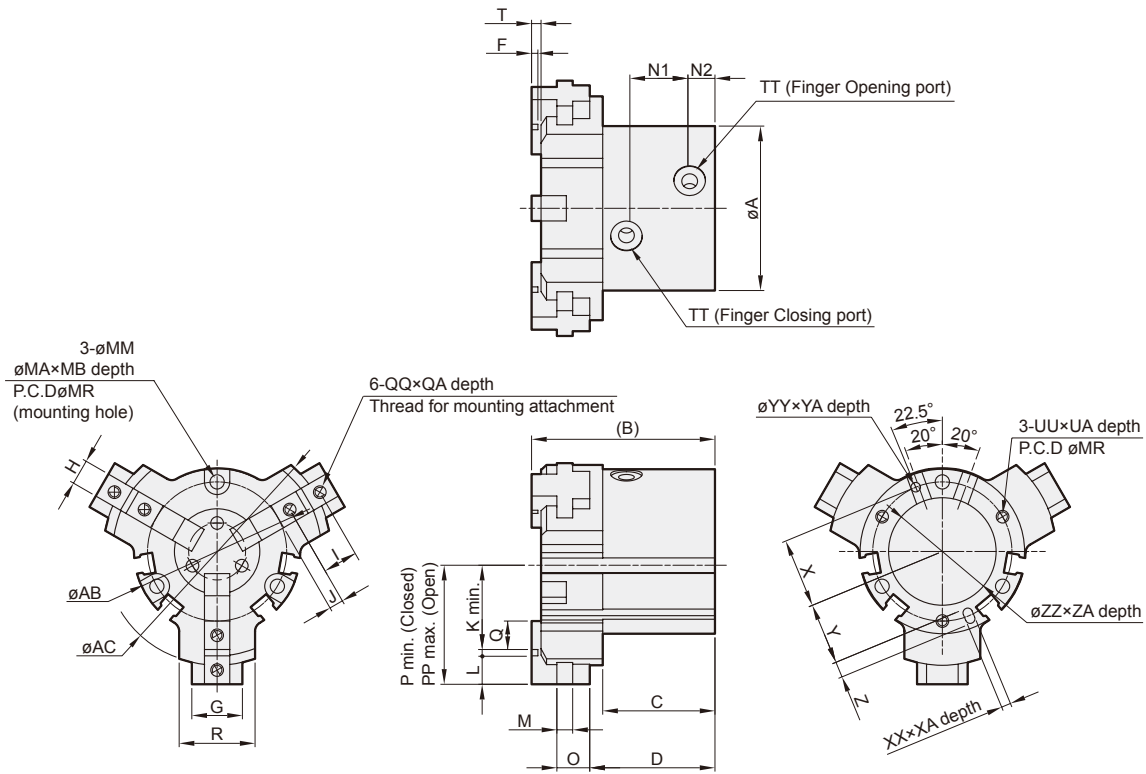

Auto switch mounting groove position (2 places)

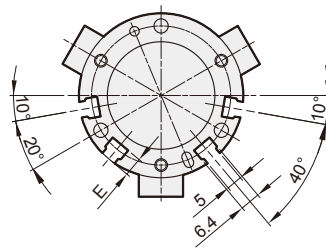

Code Tube I.D.	A	AB	AC	B	C	D	E	F	G	H	I	J	K	L	M	MA	MB	MM	MR	N1	N2	O	P	PP	Q
32	52	52.6	72	58	35.5	39.6	6	2	16	8h9 ⁺⁰ _{-0.036}	11	4.5	23	2H9 ^{+0.025} ₋₀	5	8	8	4.5	44	20	8	10.4	34	42	9
40	62	62.6	82	64	38.5	42.5	8	2	18	8h9 ⁺⁰ _{-0.036}	12	4.5	25.5	3H9 ^{+0.025} ₋₀	7	9.5	11	5.5	53	22	9	13.5	37.5	47.5	9
50	70	70.6	104	77.5	46.5	51.3	7	2	20	10h9 ⁺⁰ _{-0.036}	14	5	32	4H9 ^{+0.030} ₋₀	8	9.5	14.5	5.5	62	29	9	17.7	46	60	10
63	86	86.6	120	89	51	58.5	7.5	3	26	12h9 ⁺⁰ _{-0.043}	17	5.5	37	6H9 ^{+0.030} ₋₀	10	11	17	6.6	76	30.5	12	19.5	54	70	11
80	106	106.6	140	116	70	78.5	9	4	30	14h9 ⁺⁰ _{-0.043}	20	6	40.5	8H9 ^{+0.036} ₋₀	11	11	23	6.6	95	37.5	14	23.5	60.5	80.5	12

Code Tube I.D.	QA	QQ	R	T	TT	UA	UU	X	XA	XX	Y	YA	YY	Z	ZA	ZZ
32	8	M4 \times 0.7	24	3	M5 \times 0.8	6	M4 \times 0.7	22	3	3H9 ^{+0.025} ₋₀	19.5	3	3H9 ^{+0.025} ₋₀	5	2	34H9 ^{+0.062} ₋₀
40	8	M4 \times 0.7	30	3	M5 \times 0.8	10	M5 \times 0.8	26.5	4	4H9 ^{+0.030} ₋₀	23.5	4	4H9 ^{+0.030} ₋₀	6	2	42H9 ^{+0.062} ₋₀
50	10	M5 \times 0.8	32	3	M5 \times 0.8	10	M5 \times 0.8	31	4	4H9 ^{+0.030} ₋₀	28	4	4H9 ^{+0.030} ₋₀	6	2	52H9 ^{+0.074} ₋₀
63	10	M5 \times 0.8	40	4	M5 \times 0.8	12	M6 \times 1	38	5	5H9 ^{+0.030} ₋₀	34.5	5	5H9 ^{+0.030} ₋₀	7	2.5	65H9 ^{+0.074} ₋₀
80	12	M6 \times 1	50	5	Rc1/8	12	M6 \times 1	47.5	6	6H9 ^{+0.030} ₋₀	43.5	6	6H9 ^{+0.030} ₋₀	8	3	82H9 ^{+0.087} ₋₀