

### Symbol

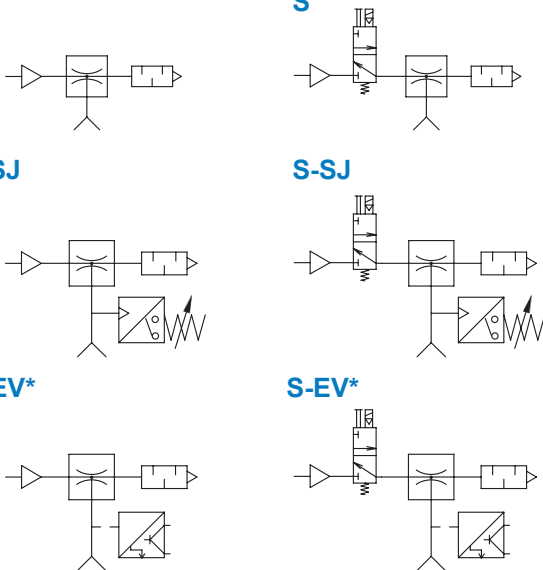

### Order example

**MVVA – 10S – SJ – G**

MODEL		PORT THREAD	
NOZZLE DIA. / TYPE		Blank: Rc thread G: G thread	
10	1.0 mm	Blank	Standard
15	1.5 mm		
20	2.0 mm		
25	2.5 mm		
30	3.0 mm		
VACUUM SWITCH TYPE			
Blank	Standard type		
SJ	Adjustable switch		
EV*	Pressure switch		
		EV1: MP41C-022 EV5: MP41C-042 EV6: MP41C-042-QD	

\* SJ, EV\* only for nozzle dia. 10~20.

### Specification

Model	MVVA					
Nozzle dia. (mm)	1.0	1.5	2.0	2.5	3.0	
Port size	Refer to dimensions page 7-31					
Medium	Air					
Operating pressure range	0.1~0.6 MPa					
Ambient temperature	0~+60°C (No freezing)					
Final vacuum	-91.8 kPa (-690mmHg)					
Suction flow (ℓ/min)	32	63	130	160	225	
Air consumption (ℓ/min)	76	100	185	265	385	
Supply pressure	0.5 MPa					
Lubricator	Not required					
Weight (g)	Standard	84	126	294	672	787
	SJ type	110	158	321	-	-
	EV type	162	197	353	-	-

Model	MVVA-S			
Nozzle dia. (mm)	1.0	1.5	2.0	
Port size	Refer to dimensions page 7-32			
Medium	Air			
Operating pressure range	0.15~0.6 MPa			
Ambient temperature	0~+60°C (No freezing)			
Final vacuum	-91.8 kPa (-690mmHg)			
Suction flow (ℓ/min)	21	65	99	
Air consumption (ℓ/min)	50	142	187	
Supply pressure	0.5 MPa			
Lubricator	Not required			
Solenoid valve	MVDY-100-3E1-DC24-SR (wire length 500mm)			
Weight (g)	S type	117	150	368
	S-SJ type	178	204	400
	S-EV type	186	226	427

\* The rated pressure of the generator in the specifications is the value when the generator is activated. Please consider the pressure drop and ensure the specification value; if it does not meet specifications, it may cause noise, unstable characteristics, and malfunction of the sensor at a certain pressure. If this happens, please reset the rated pressure.

\* The range of noise will change due to air pressure.

### Vacuum switch

Model	SJ	EV*
Medium	Air	
Pressure setting range (kPa / mm Hg)	-20.0 ~ -53 (-150 ~ -400)	-100 ~ 100 (-757.5 ~ 757.5)
Proof pressure (MPa)	0.5	0.3
Ambient temperature	0~+60°C (No freezing)	-10~+50°C (No freezing)
Ambient humidity	35~+85%RH (No condensation)	
Switch type	Reed switch, N.O	PNP, NPN open collector
Rated voltage	AC125V, AC250V	DC12~24V ±10%
Max load current (A)	5	0.125
Repeatability	±5.3 kPa	≤±0.2% F.S. ±1 digit
Hysteresis (kPa)	4.0~13.3	-
Cable length (mm)	400	2000

\* For the detailed specifications of EV\* type (MP41), please refer to page 5-13.

### Vacuum characteristics

**MVVA-10**

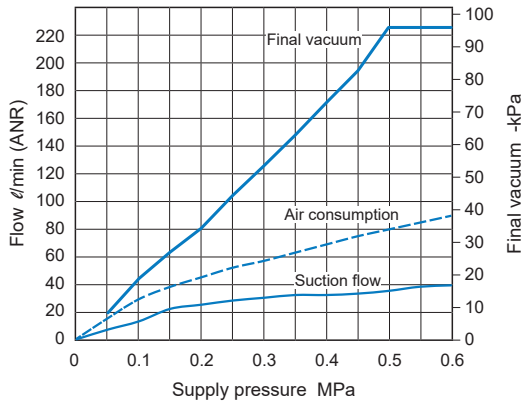

**MVVA-25**

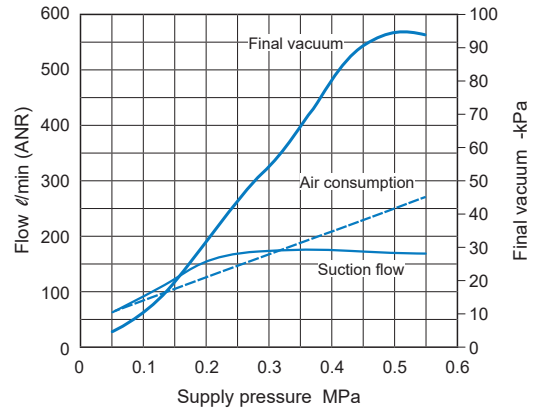

**MVVA-15**

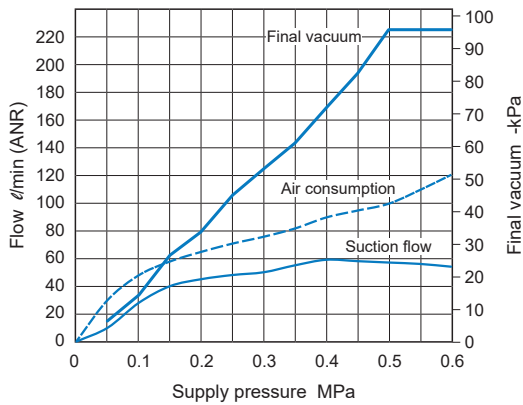

**MVVA-30**

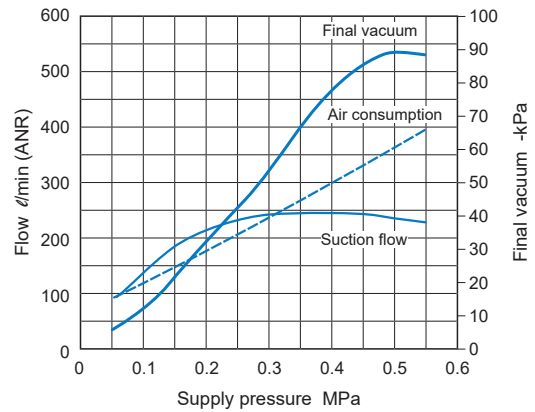

**MVVA-20**

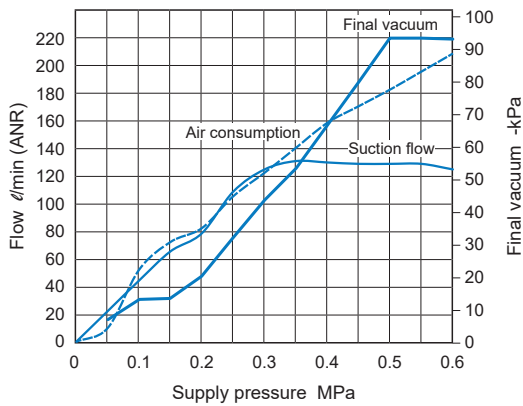

### Vacuum characteristics

#### MVVA-10S

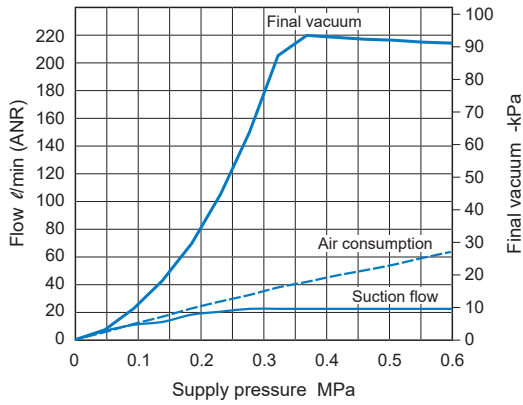

#### MVVA-15S

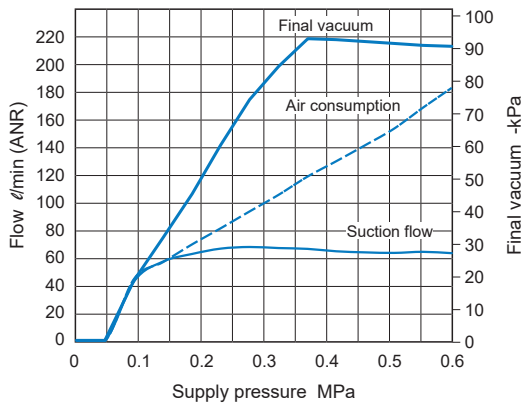

#### MVVA-20S

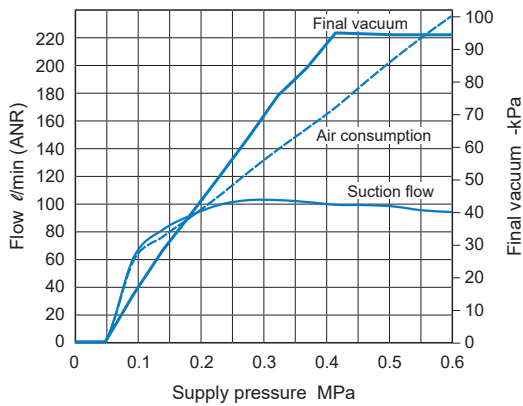

### MVVA

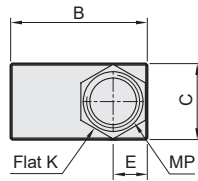
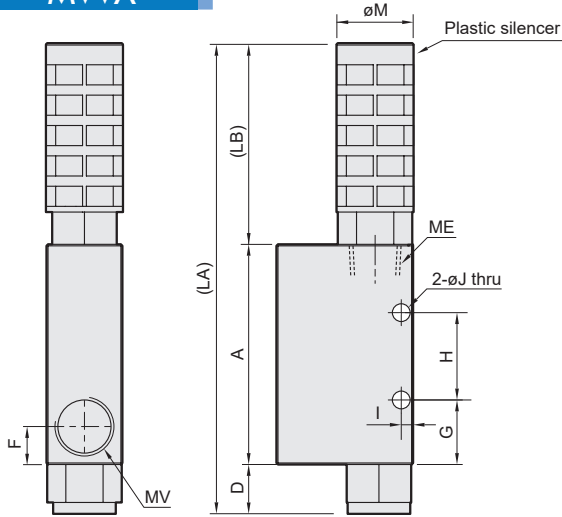

### MVVA-SJ

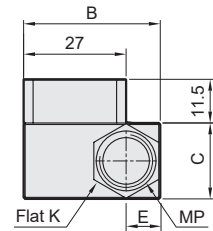
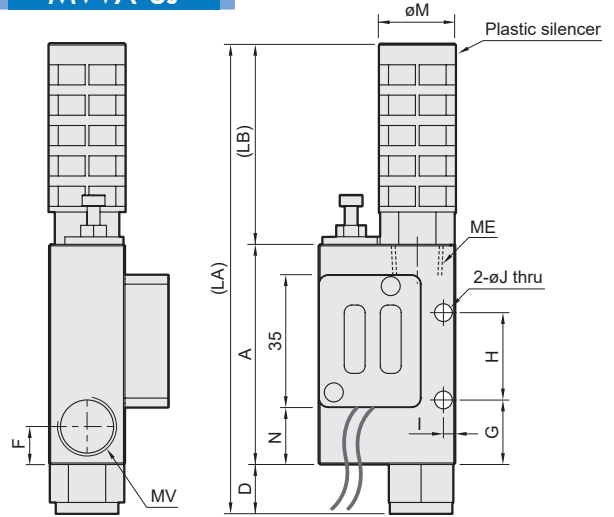

### MVVA-EV\*

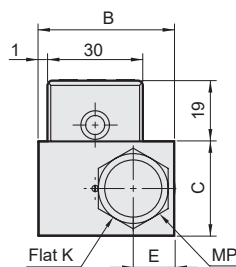
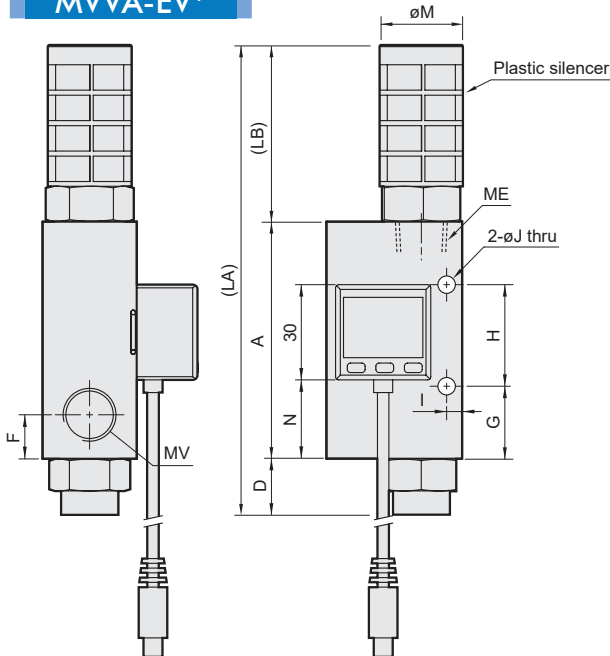

Code Model	A	B	C	D	E	F	G	H	I	J	K	LA
MVVA-10	55	34	15.5	10	9	8	13	18	3	4.3	14	91
MVVA-10-SJ	55	34	15.5	10	9	8	13	18	3	4.3	14	91
MVVA-10-EV*	55	40	16	10	9	8	13	18	3	4.3	14	91
MVVA-15	58	36	20	13	10.5	10	17	23	3.5	4.3	17	126
MVVA-15-SJ	58	36	20	13	10	10	17	23	3.5	4.3	17	126
MVVA-15-EV*	58	39	20	13	10.5	10	17	23	3.5	4.3	17	126
MVVA-20	75	43	29.5	18	13	14	23	32	5	5.5	22	151.8
MVVA-20-SJ	75	43	29.5	18	13	14	23	32	5	5.5	22	151.8
MVVA-20-EV*	75	43	29.5	18	13	14	23	32	5	5.5	22	151.8
MVVA-25	100	60	40	17	20	16	20	50	5.5	6	28	235.5
MVVA-30	115	60	40	20	20	20	33	50	5.5	6	30	235.5

### Applicable silencer

Code Model	LB	M	ME	MP	MV	N	Silencer
MVVA-10(S)	26	16	Rc1/8	Rc1/8	Rc1/8	-	MSR01-B
MVVA-10(S)-SJ	26	16	Rc1/8	Rc1/8	Rc1/8	10.5	MSR01-B
MVVA-10(S)-EV*	26	16	Rc1/8	Rc1/8	Rc1/8	20	MSR01-B
MVVA-15(S)	55	20.3	Rc1/4	Rc1/4	Rc1/4	-	MSR02-B
MVVA-15(S)-SJ	55	20.3	Rc1/4	Rc1/4	Rc1/4	14	MSR02-B
MVVA-15(S)-EV*	55	20.3	Rc1/4	Rc1/4	Rc1/4	20	MSR02-B
MVVA-20(S)	58.8	26.3	Rc3/8	Rc3/8	Rc3/8	-	MSR03-B
MVVA-20(S)-SJ	58.8	26.3	Rc3/8	Rc3/8	Rc3/8	30.5	MSR03-B
MVVA-20(S)-EV*	58.8	26.3	Rc3/8	Rc3/8	Rc3/8	25	MSR03-B
MVVA-25	118.5	38	Rc3/4	Rc3/8	Rc1/2	-	MSLE-06
MVVA-30	118.5	38	Rc3/4	Rc1/2	Rc3/4	-	MSLE-06

\* Silencer specifications please refer to page 7-2~3.

# MVVA-S Dimensions

## VACUUM GENERATOR



### MVVA-S

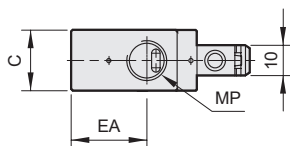
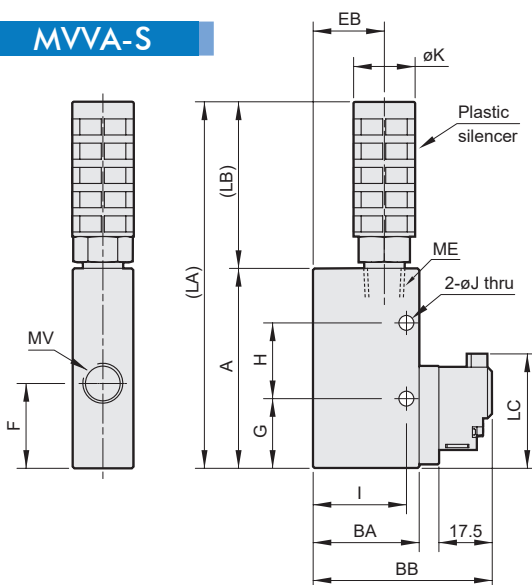

### MVVA-S-SJ

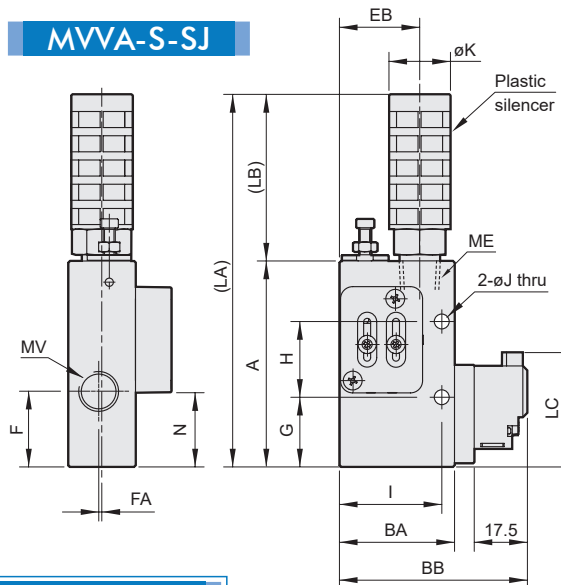

### MVVA-10S

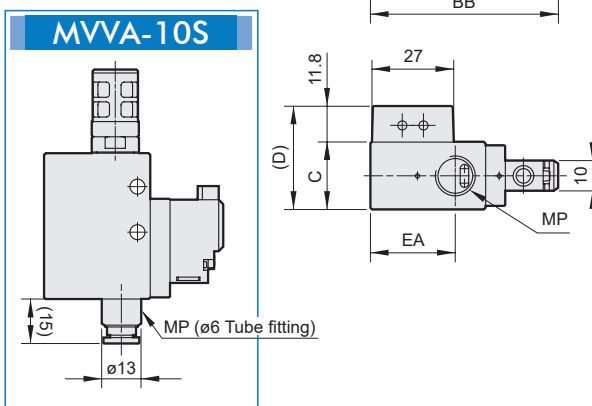

### MVVA-S-EV\*

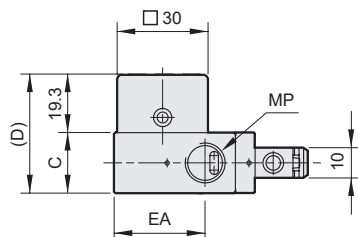
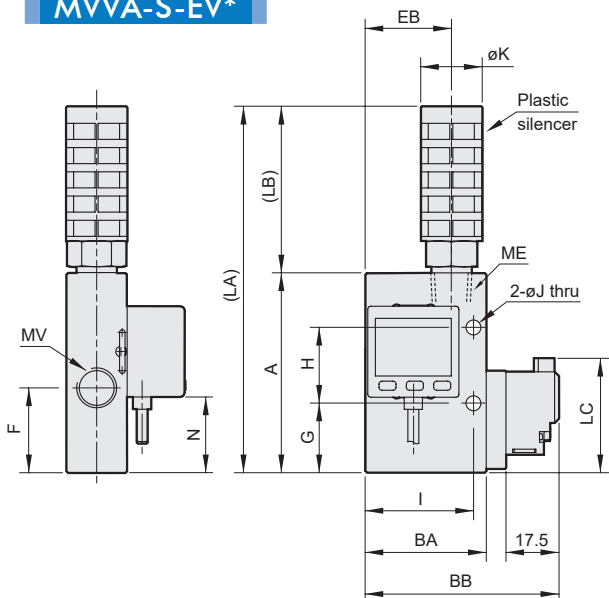

Code Model	A	BA	BB	C	D	EA	EB	F	FA	G	H
MVVA-10S	48	35	59	16	-	25.5	23.5	25	-	22	15
MVVA-10S-SJ	68	36	60	16	27.8	26.5	24.5	24	1	22	25
MVVA-10S-EV*	48	40	64	16	35.3	30.5	28.5	29	-	22	15
MVVA-15S	66	35	59	20	-	25	23.5	28	-	23	24
MVVA-15S-SJ	68	38	62	22	34.8	28	26.5	25	1.2	23	24
MVVA-15S-EV*	66	40	64	20	39.3	30	28.5	28	-	23	24
MVVA-20S	85	50	74	29.5	-	36.5	32	33.5	-	28	32
MVVA-20S-SJ	85	50	74	29.5	41.3	36.5	32	33.5	-	28	32
MVVA-20S-EV*	85	50	74	29.5	48.8	36.5	32	33.5	-	28	32

Code Model	I	J	K	LA	LB	LC	N	ME	MP	MV
MVVA-10S	30.8	4.3	16	94	31	37.2	-	Rc1/8	ø6	Rc1/8
MVVA-10S-SJ	31.8	4.3	16	114	31	37.2	24.5	Rc1/8	ø6	Rc1/8
MVVA-10S-EV*	35.8	4.3	16	96	31	37.2	2.5	Rc1/8	ø6	Rc1/8
MVVA-15S	30.8	4.3	20.3	121	55	37.9	-	Rc1/4	Rc1/4	Rc1/4
MVVA-15S-SJ	33.8	4.3	20.3	123	55	37.9	24.5	Rc1/4	Rc1/4	Rc1/4
MVVA-15S-EV*	35.8	4.3	20.3	121	55	37.9	25	Rc1/4	Rc1/4	Rc1/4
MVVA-20S	43	6	26.3	144	58.8	40.7	-	Rc3/8	Rc3/8	Rc3/8
MVVA-20S-SJ	43	6	26.3	144	58.8	40.7	40.5	Rc3/8	Rc3/8	Rc3/8
MVVA-20S-EV*	43	6	26.3	144	58.8	40.7	21	Rc3/8	Rc3/8	Rc3/8

\* Applicable silencer please refer to page 7-30.